

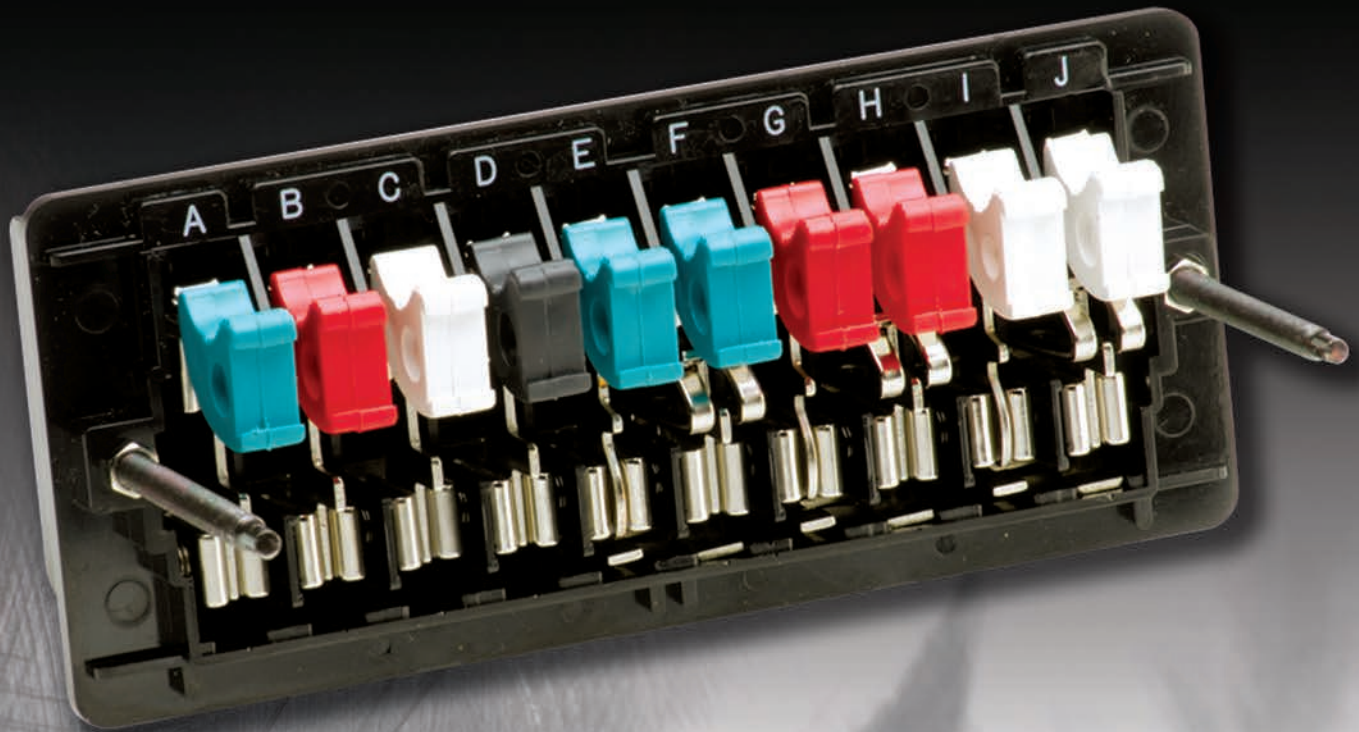

FMS

Semiflush-Mounted Test Switches



- Select from 1-10, 1-14, 1-30, or any combination of test switches
- Safe, durable, rugged and reliable
- Choice of black or clear covers with provision to apply seal
- UL recognized 
- CSA Certified 
- Nuclear rated switches
NFMS 10 & NFMS 14 pole versions

STATES®

The STATES FMS Semiflush-Mounted Test Switches provide a compact, versatile means to disconnect, test or measure devices and circuits in panelboards such as relays, metering, control circuits and other instrumentation applications. The FMS switch works without instrument transformers being disconnected from secondary wiring.

The FMS switch is the result of many decades of experience in the design and manufacture of test switches. Many features are incorporated for safety, ease of use, durability and security.

FMS TEST SWITCH BENEFITS

- **No downtime:** Measurements of voltage and current may be made without taking the device out of service.
- **Easy access:** All measurements and tests are performed at the front of the panelboard. This feature saves time and provides better safety and system security.

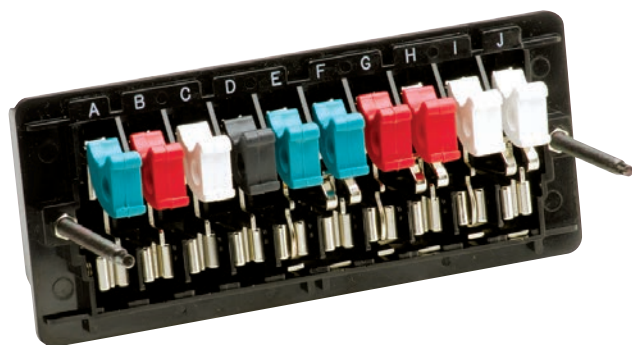

FMS 10-pole test switch

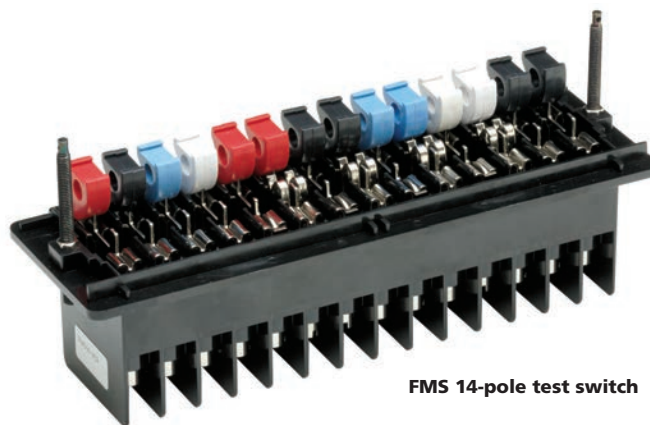

FMS 14-pole test switch

- **Secure:** The FMS 10, 14 & 30 pole deeper, wider, clear covers come with a “knockout” tab for a safety lock (not included), that can be used with our optional FMS Lockout Kit. Part No. FMSLOCK-1. The cover screws, which come standard, have a hole in the tip to insert the wire of a meter-type lead seal (not included). This will help deter unauthorized access to the switch.
- **Use standard plugs:** The test-clip feature allows connections using standard spring-clip test leads. Test connections also can be made using STATES Dual Circuit Plug (Part No. 15000), the STATES 10 Pole Test Paddle (Part No. V1TP10) or the STATES 14 Pole Test Paddle (Part No. FTP14).
STATES recommends the use of Part No. 15000 on all of its' test switches.
Use of any other manufacturer's plug could damage the switch and may void the warranty.
- **Safe to use:** Current switches automatically short-circuit current transformer secondaries when the switches are opened for test-plug insertion.
- **Choice of operation:** To provide testing flexibility, the FMS Switches can be operated independently, or two or more can be connected using the yoking bar to perform specific testing requirements.
- **Cost-saving advantage:** The FMS 10-pole test switch can be used as a direct replacement for many competitor test switches. In most cases you do not have to cut new holes or make any modifications.
- **Optional clear cover:** See at a glance if a switch blade is open or closed with the optional deeper, wider, clear cover. A deep ridge prevents the blade from opening or closing.

FMS Semiflush-Mounted Test Switches

The FMS switch base and cover is made of molded, flame-retardant ABS plastic, which provides a tough, flexible, insulated enclosure. Individual test switches are a knife-blade type and are separated by insulating barriers that are part of the molded base. Molded switch handles have a dovetail indentation to accept marker cards for circuit identification.

The individual FMS switch bases contain 10 or 14 positions and offer 1-10, 1-14 or 1-30 (consisting of 3, 10-pole bases) combinations.

The current switches have the necessary make-before-break short-circuit feature. A hole is provided in each handle to allow insertion of a yoke bar to gang switch operations together.

Two types of connections are offered on the back of the FMS test switch. Screw terminals are standard. Stud connections are optional. To specify stud connections, refer to **Ordering Information**. Either connection is separated by molded insulating barriers. The width between barriers is sufficiently wide enough for a standard spin-tight tool to be inserted for installation or removal of wire.

Covers

The FMS test switch comes standard with a black cover and the option of a clear cover. Both cover types completely seal the switches. Clear cover kits are also available to replace existing black covers, refer to **Ordering Information**.

Color-coded handles

Unless otherwise specified, **potential** elements have **red handles**, and **current** elements have **black handles**. Additionally, the following other handle colors are available at extra cost: blue, orange, white, yellow, green, brown and purple.

Identification card holder

Each handle is slotted for insertion of an identification card for marking or coding. Cards are available under Part No. 680001.

Recognized by UL & CSA

STATES FMS Test Switch is recognized by Underwriters Laboratories Inc., UL File E225664, with a rating of 600 volts, 30 amps, and is certified by CSA, Certificate 1281976. For additional information, go to www.ul.com.

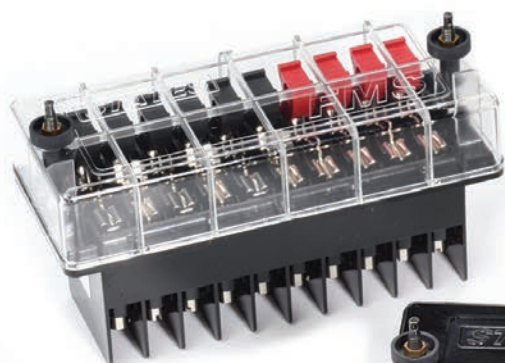

10 Pole Clear Narrow Cover

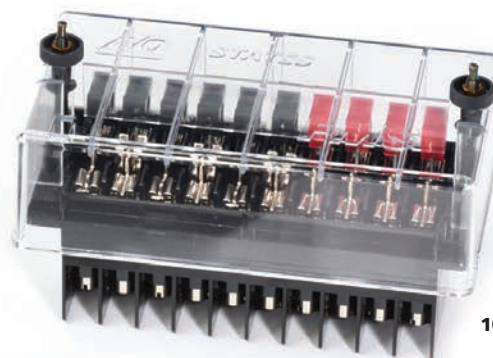

10 Pole Clear Wide Cover



10 Pole Black Cover

Deep ridge prevents a switch blade from opening or closing



Optional clear covers for STATES FMS Test Switch

Cover completely seals test switch



14 Pole Clear Wide Cover



14 Pole Clear Narrow Cover



14 Pole Black Cover

STATES NUCLEAR RATED FMS TEST SWITCHES

The line of NFMS Test Switches, NFMS10 & NFMS14, were designed for Class 1E applications. Class 1E as described per IEEE323-1974/83 & IEEE 323-1975/87, is the safety classification of the electric equipment and systems that are essential to emergency reactor shutdown, containment isolation, reactor core cooling, and containment and reactor heat removal, or otherwise are essential in preventing significant discharge of radioactive material to the environment.

These test switches are manufactured of Polyetherimide material (switch base and cover) and a copper and bronze alloy with nickel plating on the metal conductive parts to

prevent corrosion. The switches were tested following IEEE 323-1974/83 & IEEE 323-1975/87 standards for Class 1E applications. They were exposed to radiation tests, 500 cycles of mechanical operations and rated current and voltage as well as being subjected to a 24 hour, 212°F superheated steam oven and seismic tests. The standard for Class 1E requires that all components have a 40 year life work cycle.



NFMS 10 Pole

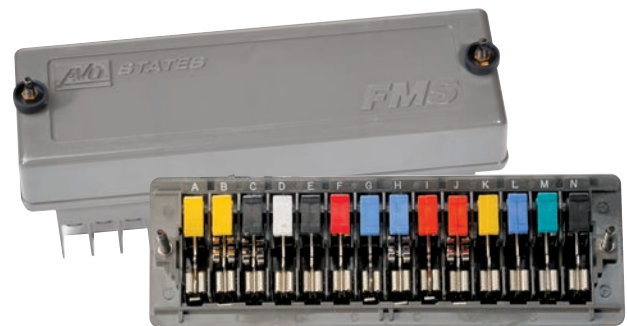

NFMS 14 Pole

SPECIFICATIONS



Style - FMS	FMS10	FMS14	NFMS10	NFMS14	FMS19	R19
Brief Description	10 Pole Test Switch Semi-Flush Mounted	14 Pole Test Switch Semi-Flush Mounted	Nuclear Rated 10 Pole Test Switch Semi-Flush Mounted	Nuclear Rated 14 Pole Test Switch Semi-Flush Mounted	FMS 19inch Rack Mounting System Semi-Flush Mounted	R19 Rack Mounting System Semi-Flush Mounted
Typical Applications	Sub-Station Monitoring Relay Panels Metering	Sub-Station Monitoring Relay Panels Metering	Sub-Station Monitoring Relay Panels Metering	Sub-Station Monitoring Relay Panels Metering	Sub-Station Monitoring Relay Panels Metering	Sub-Station Monitoring Relay Panels Metering
Certifications	UL, CSA UL File E225664	UL, CSA UL File E225664	UL, CSA UL File E225664 IEEE 323-1974/83 - IEEE 323-1975/87	UL, CSA UL File E225664 IEEE 323-1974/83 - IEEE 323-1975/87	UL, CSA UL File E225664	UL, CSA UL File E225664
Voltage Rating	600VAC	600VAC	600VAC	600VAC	600VAC	600VAC
Current Rating	30A	30A	30A	30A	30A	30A
Recommended Wire Size Range	Min 14awg Max 10awg	Min 14awg Max 10awg	Min 14awg Max 10awg	Min 14awg Max 10awg	Min 14awg Max 10awg	Min 14awg Max 10awg
Recommended Wire Lug Size	#10	#10	#10	#10	#10	#10
Screw Thread	8-32	8-32	8-32	8-32	8-32	8-32
Recommended Torque for Screw Wiring Connections	Max 15in/lbs	Max 15in/lbs	Max 15in/lbs	Max 15in/lbs	Max 15in/lbs	Max 15in/lbs
Stud Thread	10-32	10-32	10-32	10-32	10-32	10-32
Recommended Torque for Stud Wiring Connections	Max 25in/lbs	Max 25in/lbs	Max 25in/lbs	Max 25in/lbs	Max 25in/lbs	Max 25in/lbs
Ambient Temperature	104° F (40° C)	104° F (40° C)	131° F (55° C)	131° F (55° C)	104° F (40° C)	104° F (40° C)

STATES TYPE FMS 10 & 14 POLE TEST SWITCHES

Understanding FMS 10 & 14 Pole Part Numbers				
Size of Switch Base	1	2	3	4
	Cover Type	Number of Poles	Arrangement Designator	Terminal Type
10 Pole	FMS - Black Cover 2FMS - Deeper, Wider Clear Cover 3FMS - Narrow Clear Cover CI-FMS - Bottom Slotted Black Cover NFMS - Nuclear Rated Cover (Gray)	01 - 10	This is the letter and/or number designation that has been assigned for a particular arrangement See catalog page 26, or visit our website at www.statesproducts.com for arrangement options	Switches are provided with screw terminals unless otherwise specified by adding -ST for Stud Terminals

Size of Switch Base	1	2	3	4
	Cover Type	Number of Poles	Arrangement Designator	Terminal Type
14 Pole	FMS14 - Black Cover 2FMS14 - Deeper, Wider Clear Cover 3FMS14 - Narrow Clear Cover CI-FMS14 - Bottom Slotted Black Cover NFMS14 - Nuclear Rated Cover (Gray)	01 - 14	This is the letter and/or number designation that has been assigned for a particular arrangement See catalog page 26, or visit our website at www.statesproducts.com for arrangement options	Switches are provided with screw terminals unless otherwise specified by adding -ST for Stud Terminals

EXAMPLES

<u>3FMS</u> 1	—	<u>06 A</u> 2 3	—	<u>ST</u> 4
------------------	---	--------------------	---	----------------

Part No. 3FMS-06A-ST

6 Switches in a 10 pole base, with a narrow clear cover and stud terminals.

<u>2FMS</u> 1	—	<u>10 A</u> 2 3
------------------	---	--------------------

Part No. 2FMS-10A

10 Switches in a 10 pole base, with a deeper, wider clear cover and screw terminals.

<u>FMS14</u> 1	—	<u>14 A1</u> 2 3
-------------------	---	---------------------

Part No. FMS14-14A1

14 Switches in a 14 pole base, with a black cover and screw terminals.

<u>NFMS</u> 1	—	<u>10 E1</u> 2 3
------------------	---	---------------------

Part No. NFMS-10E1











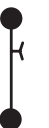

10 Switches in a nuclear rated 10 pole base with a nuclear rated cover and screw terminals.

<u>NFMS14</u> 1	—	<u>14 A</u> 2 3	—	<u>ST</u> 4
--------------------	---	--------------------	---	----------------

Part No. NFMS14-14A-ST

14 Switches in a nuclear rated 14 pole base with a nuclear rated cover and stud terminals.

FMS SWITCH ELEMENTS

<p>1</p>  <p>Single-Pole Potential</p>	<p>2</p>  <p>Ganged Double-Pole Potential</p>	<p>16</p>  <p>Ganged Three-Pole Potential</p>
<p>8</p>  <p>Current Test Jack Without Blade</p>	<p>9</p>  <p>Current Test Jack</p>	<p>10</p>  <p>Right-Hand Current Assembly Consists of Test Jack and Short-Circuiting Current Assemblies</p>
<p>5</p>  <p>Short-Circuiting Assembly With Left-Hand Common Bar</p>	<p>6</p>  <p>Short-Circuiting Assembly With Right-Hand Common Bar</p>	<p>24</p>  <p>Through Bar</p>
<p>11</p>  <p>Left-Hand Current Assembly Consists of Test Jack and Short-Circuiting Current Assemblies</p>	<p>13</p>  <p>Ganged Two-Pole Short-Circuiting Current Assembly</p>	<p>20</p>  <p>Ganged Three-Pole Short-Circuiting Current Assembly, Right Extension</p>
<p>26</p>  <p>Blank Space</p>	<p>For the most up-to-date information, please visit our website – www.StatesProducts.com</p>	

NOTES:

1. Base molded barriers are provided between poles of opposite polarity.
2. **Potential** handles are **red** and **current** handles are **black** unless otherwise specified.
3. Specify adjacent handles to be ganged (yoked) if desired.
4. Black potential blade available. (Use "k" in arrangement, example: 1k-1k-1k)
5. For stud connections add "ST" as suffix. (Example, FMS-05A-ST)
6. Arrange elements, front view, left to right.
7. When using the #20 element, please use either the #8, #9, or #24 element on the right for the right extension to connect to. (Example, 20-9-1-1-1-1-1-1)

ORDERING INFORMATION

SPECIAL ORDERS

Special Arrangements: In addition to the typical arrangements shown on pages 25-40, special arrangements are available. These can be made of any combination of potential or current elements, with a maximum of 10 or 14 poles. For more information, refer to the following example and illustrations on Page 19.

Example:

To order a customized, 10 or 14-pole Switch, specify:

Switch Type: STATES Type FMS
No. of poles: 10 or 14-pole Test Switch
Arrangement*: 1-10-1-10-1-10-1

Terminal Type: Specify stud or screw terminal
Cover Type: Black, Clear (deeper, wider or narrow)

***Arrangements should be given as front view of switch, left to right, using the elements listed on page 20.**

Handle Colors: The standard colors for handles are **red** for **potential** and **black** for **current**. Handles are also available in other colors.

To specify non-standard colors, add to the element number the appropriate color code:

Color	Color Code
Black	k
Red	r
Blue	b
Orange	e
White	w
Green	g
Yellow	y
Brown	n
Purple	p

To order a switch with handles in non-standard colors

You must specify the arrangement with colors indicated. For example, to order a 2-pole switch with special handle colors, specify: **Arrangement: 1y-1y. This replaces the standard red handles with yellow handles.**

Ganged handles

You may specify a yoking bar to gang adjacent handles. For example, to order a switch with the adjacent potentials ganged, you must specify: **Gang all potentials**

On the following FMS 10 & 14 pole catalog arrangement pages, the ganged handles are represented with the number (#) sign.

Example: #1-1-1-1-1-1-1-1-1-1# (all handles in between the “#” are ganged together)

Nuclear Rated FMS Test Switches

The Nuclear Rated FMS Test Switches are available in 1 – 10 and 1 – 14 pole arrangements with opaque covers.

To order, simply add the prefix N to the beginning of any of the switches listed.

Example: 10 Pole – NFMS-10A or NFMS-10A-ST
 14 Pole – NFMS14-14A1 or NFMS14-14A1-ST

NOTE: Clear covers are not available for the nuclear rated switches.

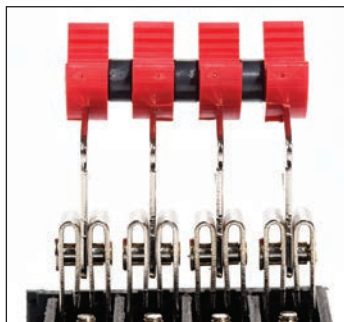

Detailed view of ganged handles. See page 64 for ganging kit information.

OPTIONAL ACCESSORIES



Dual Circuit Plug

By inserting the STATES Dual Circuit Plug (Part No. 15000) into the test jack, safe measurement can be made of current transformer secondary current.

STATES recommends the use of Part No. 15000 on all of its' test switches.

Use of any other manufacturer's plug could damage the switch and may void the warranty.

Identification cards

Each switch handle is slotted for insertion of an identification card for marking or coding. Cards are available under Part No. 680001.



Test Paddle

The 10 and 14 pole potential test paddles are feature packed and have been designed to make a test technician's job easier.

Handle – use one hand to connect to test switch.

Labeled – locate connector to corresponding switch.

Use for STATES FMS Test Switch.

Part No. V1TP10 - 10 Pole Test Paddle

Part No. FTP14 - 14 Pole Test Paddle

See Testing Accessories on page 128.

Typical Wiring Diagram

FMS
Test Switches

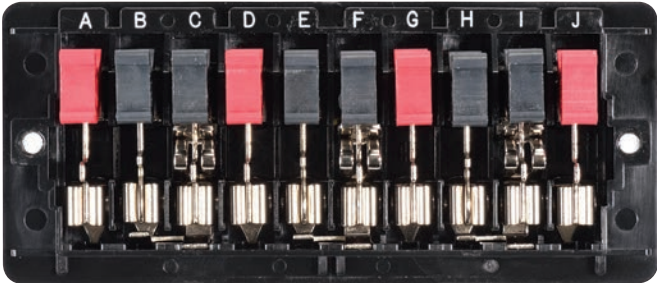
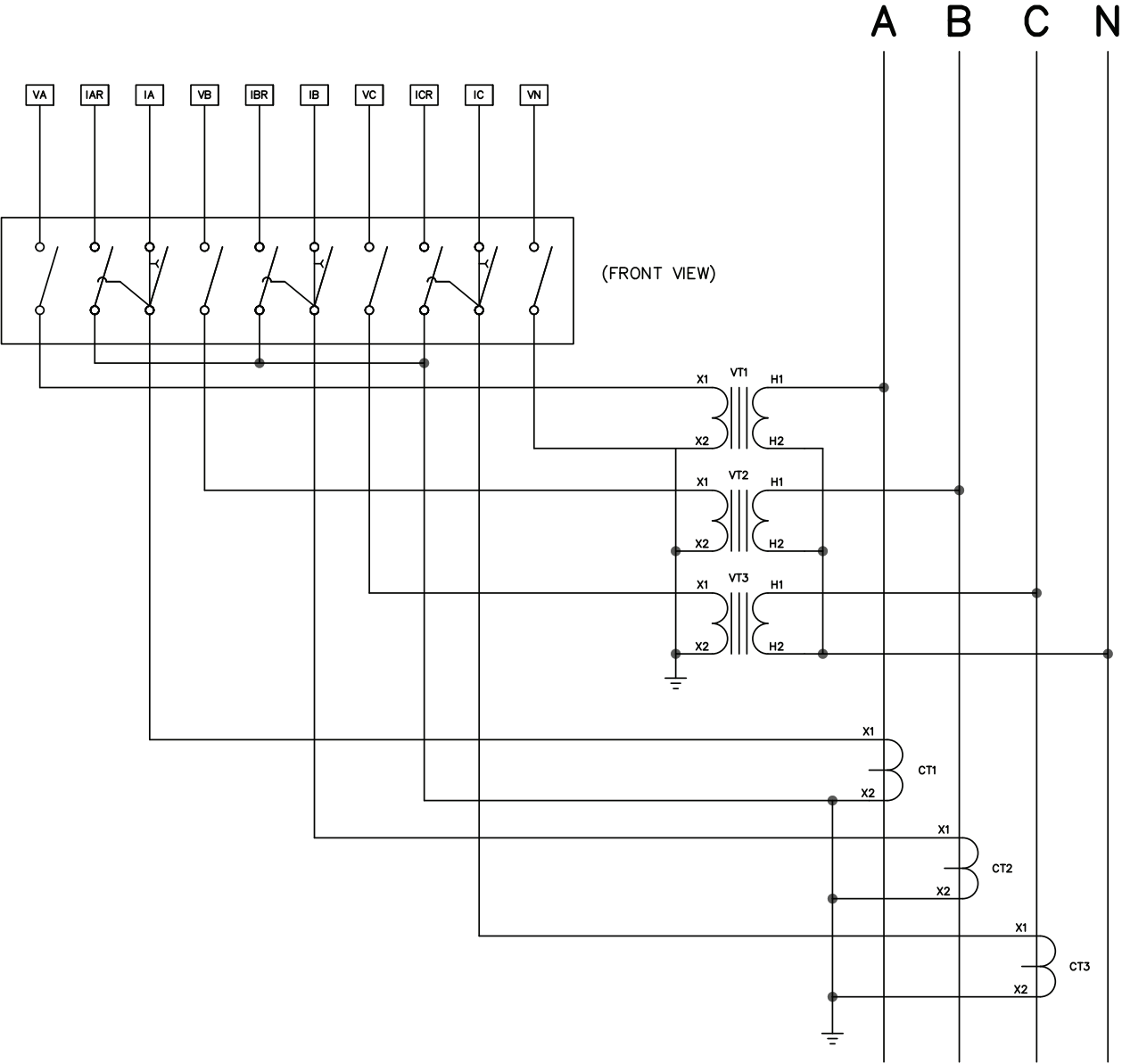

FMS-10C-ST (ARR: 1-10-1-10-1-10-1)



FMS-10C-ST back view. Also shown is the center insert used for the optional back cover attachment.

NARROW CLEAR AND BLACK COVERS

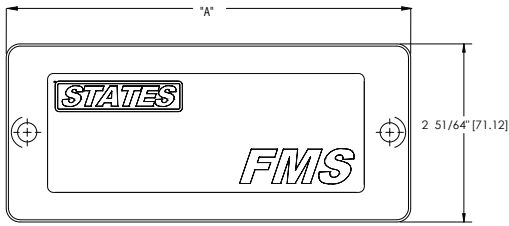

POLE	"A" DIMENSION
10	6 23/64" [161.5]
14	8 7/16" [214.3]
30	17 45/64" [449.6]

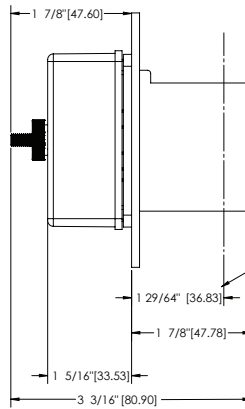

THIS DIMENSION
TO TOP OF LUG
MOUNTING NUT
IN ASSEMBLY

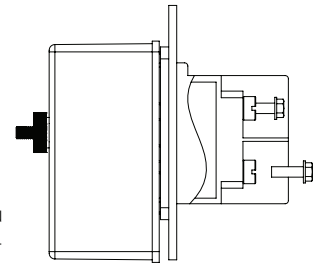

Cut-away side view of
screw terminals

DEEPER, WIDER CLEAR COVER

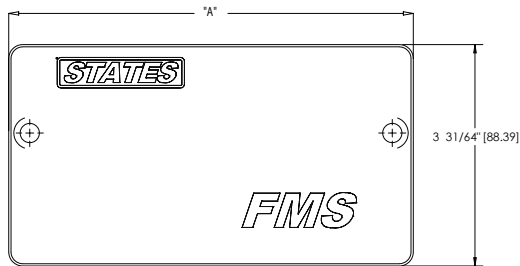

POLE	"A" DIMENSION
10	6 23/64" [161.5]
14	8 7/16" [214.3]
30	17 45/64" [449.6]

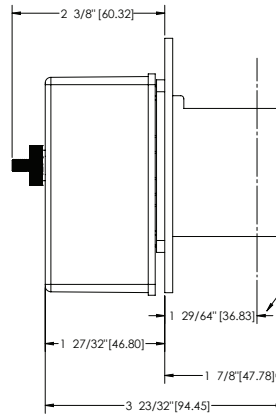

THIS DIMENSION
TO TOP OF LUG
MOUNTING NUT
IN ASSEMBLY

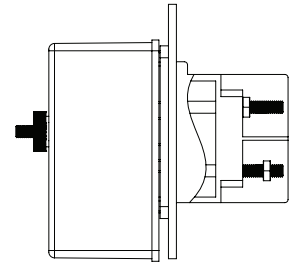

Cut-away side view of
stud terminals

TYPE FMS 14-POLE TEST SWITCH DIMENSIONS IN INCHES [MM]

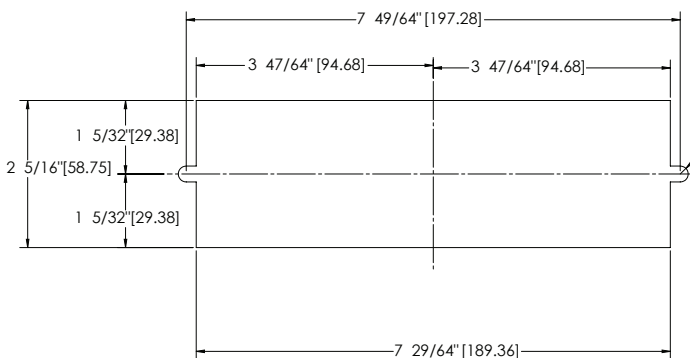

TYPE FMS 10-POLE TEST SWITCH DIMENSIONS IN INCHES [MM]

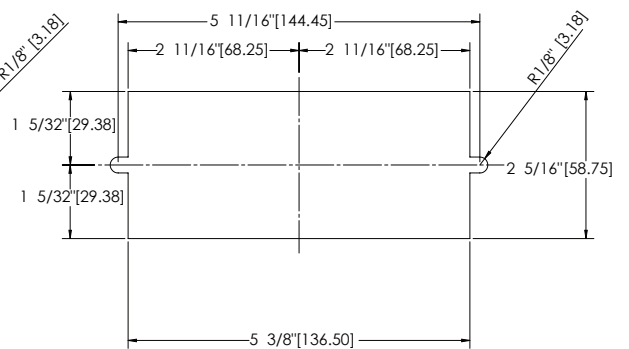

OPTIONAL ACCESSORIES

FMS
Test Switches



FMS Back Covers

See page 64 for **Back Cover
Ordering Information.**



V1TP10
Test Paddle

15000 Dual Circuit Plug

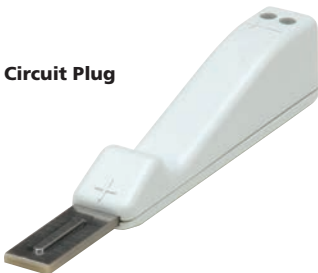

See Testing Accessories on page 128

FRONT VIEW

6-POLE

26-26-26-26-1-1-1-1-1-1

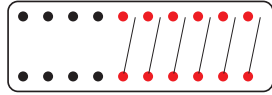

FMS-06A

26-26-26-26-2-2-2

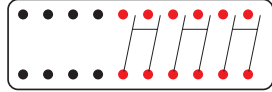

FMS-06B

26-26-26-26-1-1-1-10-1

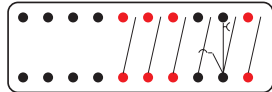

FMS-06C

26-26-26-26-9-9-9-9-9-9

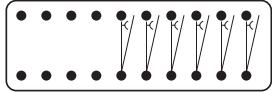

FMS-06D

26-26-26-26-1-1-10-10

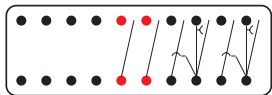

FMS-06E

26-26-26-26-10-10-10

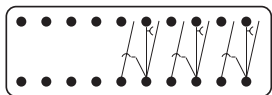

FMS-06F

7-POLE

26-26-26-1-1-1-1-1-1-1

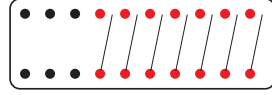

FMS-07A

26-26-26-9-9-9-9-9-9-9

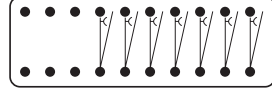

FMS-07B

26-26-26-1-10-1-10-1

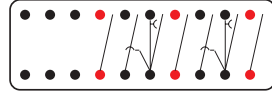

FMS-07C

26-26-26-1-1-1-10-10

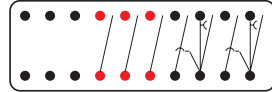

FMS-07D

26-26-26-1-10-10-10

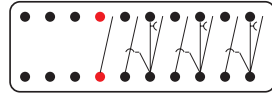

FMS-07E

8-POLE

26-26-1-1-1-1-1-1-1-1

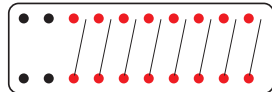

FMS-08A

26-26-2-2-2-2

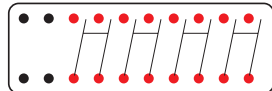

FMS-08B

26-26-9-9-9-9-9-9-9

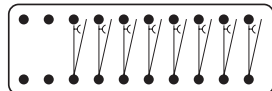

FMS-08C

26-26-1-10-1-1-10-1

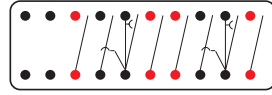

FMS-08D

26-26-1-1-1-10-1-10

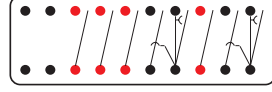

FMS-08E

26-26-10-10-10-10

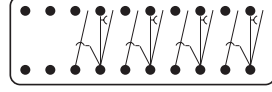

FMS-08F

9-POLE

26-1-1-1-1-1-1-1-1-1

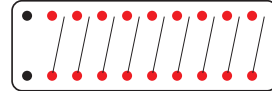

FMS-09A

26-16-16-16

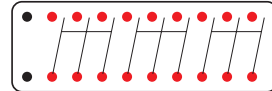

FMS-09B

26-9-9-9-9-9-9-9-9

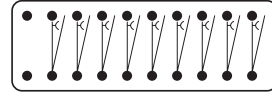

FMS-09C

26-1-10-1-10-1-10

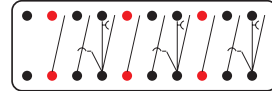

FMS-09D

26-1-1-1-10-10-10

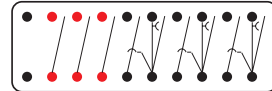

FMS-09E

10-POLE

1-1-1-1-1-1-1-1-1-1

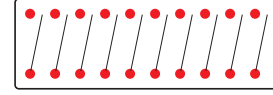

FMS-10A

9-9-9-9-9-9-9-9-9-9

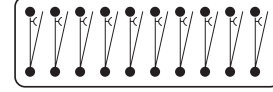

FMS-10B

1-10-1-10-1-10-1

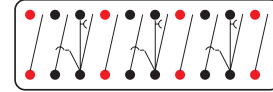

FMS-10C

1-1-1-1-10-10-10

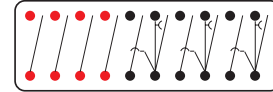

FMS-10D

1-1-1-10-10-10-1

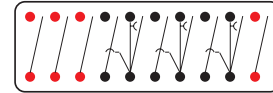

FMS-10E

10-10-10-10-10

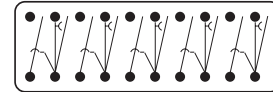

FMS-10F

FMS Semiflush-Mounted Test Switches

FMS 10 Pole Test Switches

Part Number	Arrangement	R19 Rack Code
FMS-06A	26-26-26-26-1-1-1-1-1-1	06A
FMS-06A1	26-26-26-26-1K-1K-1K-1K-1K-1K	6A1
FMS-06B	26-26-26-26-2-2-2	06B
FMS-06C	26-26-26-26-1-1-1-10-1	06C
FMS-06D	26-26-26-26-9-9-9-9-9-9	06D
FMS-06E	26-26-26-26-1-1-10-10	06E
FMS-06F	26-26-26-26-10-10-10	06F
FMS-06G	1K-1K-1K-1K-26-26-26-26-1K-1K	06G
FMS-06H	1K-1K-1K-26-26-26-26-1K-1K-1K	06H
FMS-06I	26-26-26-1K-1K-1K-1K-1K-1K-26	06I
FMS-06J	1K-26-26-26-26-1K-1K-10-1K	06J
FMS-06K	1K-1K-26-26-26-26-9-10-1K	06K
FMS-06L	1K-26-26-26-26-10-10-1K	06L
FMS-06M	9-26-9-26-9-26-26-9-9-9	06M
FMS-06N	26-10-26-10-26-10-26	06N
FMS-06P	26-26-9-9-9-9-9-9-26-26	06P
FMS-06Q	26-26-26-10-10-10-26	06Q
FMS-06R	26-26-26-9-9-9-9-9-9-26	06R
FMS-06S	1K-26-26-26-26-1K-1K-10R-1K	06S
FMS-06T	26-26-26-10R-10R-10R-26	06T
FMS-06U	26-9-9-9-26-26-1-1-1-26	06U
FMS-06V	26-26-26-26-2K-2K-2K	06V
FMS-06W	26-26-10-2-2-26-26	06W
FMS-06X	26-26-26-10KE-10KG-10KR-26	06X
FMS-06Y	1K-1K-1K-1K-1K-1K-26-26-26-26	06Y
FMS-06Z	26-26-1-1-9-9-9-9-26-26	06Z
FMS-06AB	26-2-26-2-26-2-26	6AB
FMS-06AC	26-26-26-26-#1-1-1-1-#10#	6AC
FMS-06AD	26-1-1-26-1-1-26-10-26	6AD
FMS-06AE	26-1-1W-26-1-1W-26-1-1W-26	6AE
FMS-06AF	10-10-10-26-26-26-26	6AF
FMS-06AG	#1-1-1-1-#2-26-26-26-26	6AG
FMS-06AH	16-1-2-26-26-26-26	6AH
FMS-06AJ	2K-1-1Y-1B-1W-26-26-26-26	6AJ
FMS-06AK	2K-2K-2K-26-26-26-26	6AK
FMS-06AL	26-26-26-26-10-1B-1B-2	6AL
FMS-06AM	16Y-26-26-26-26-16B	6AM
FMS-06AN	1B-1B-1-1-1-1-26-26-26-26	6AN
FMS-06AO	1B-1B-1-1-1Y-1Y-26-26-26-26	6AO
FMS-06AP	1K-1K-1K-1-1-1K-26-26-26-26	6AP
FMS-06AQ	16-26-26-26-26-16	6AQ
FMS-06AR	1-1-1-1-2K-26-26-26-26	6AR
FMS-06AS	1-1-1-1-1-1-26-26-26-26	6AS
FMS-06AT	2-2-2-26-26-26-26	6AT
FMS-06AU	26-26-26-10EK-10EK-10EK-26	6AU
FMS-06AV	1B-1B-1B-1B-1B-1B-26-26-26-26	6AV
FMS-06AW	1-16-10-26-26-26-26	6AW
FMS-06AX	1Y-1Y-26-26-1G-1G-1Y-1Y-26-26	6AX
FMS-06AY	1W-1W-26-26-1K-1K-26-26-1W-1W	6AY
FMS-06AZ	#6-6-6-6-1K-1K-26-26-26-26	6AZ
FMS-06BA	#9-9-9-9-1-1-#26-26-26-26	6BA
FMS-06BC	1-1-1-1-26-26-26-26-1-1	6BC

FMS 10 Pole Test Switches

Part Number	Arrangement	R19 Rack Code
FMS-06BD	1-1-26-26-1-1-26-26-1-1	6BD
FMS-06BE	2-26-2-26-2-26-26	6BE
FMS-06BF	10R-10R-10R-26-26-26-26	6BF
FMS-06BL	10-9-26-10-9-26-26-26	6BL
FMS-06BM	1-1-1-1-26-1-1-26-26-26	6BM
FMS-06BN	1-1-26-1-1-1-1-26-26-26	6BN
FMS-06BO	24-1K-1K-1K-1-1-26-26-26-26	6BO
FMS-06BP	26-26-26-26-1W-1W-1W-1W-1W-1W	6BP
FMS-07A	26-26-26-1-1-1-1-1-1-1	07A
FMS-07B	26-26-26-9-9-9-9-9-9-9	07B
FMS-07C	26-26-26-1-10-1-10-1	07C
FMS-07D	26-26-26-1-1-1-10-10	07D
FMS-07E	26-26-26-1-10-10-10	07E
FMS-07F	1K-1K-1K-1K-26-26-1K-1K-1K-26	07F
FMS-07G	1K-1K-1K-1K-26-26-26-1K-1K-1K	07G
FMS-07H	26-1K-1K-1K-1K-1K-1K-26-26	07H
FMS-07I	1K-26-26-1K-1K-1K-1K-1K-26	07I
FMS-07J	1K-26-26-1K-1K-1K-26-1K-1K-1K	07J
FMS-07K	1K-1K-1K-1K-1K-26-26-10-26	07K
FMS-07L	1K-1K-26-26-26-10-1K-1K-1K	07L
FMS-07M	1K-10-1K-26-26-26-1K-1K-1K	07M
FMS-07N	1K-1K-9-26-9-26-9-26-1K-1K	07N
FMS-07P	1K-1K-1K-26-26-10-10-26	07P
FMS-07Q	1K-1K-26-26-26-10-10-1K	07Q
FMS-07R	1K-9-9-26-9-26-9-26-1K-1K	07R
FMS-07S	26-26-26-9-10-10-10	07S
FMS-07T	26-26-26-1-1-1-1-10-1	07T
FMS-07U	26-26-26-1-#10#-1-#10#-1	07U
FMS-07V	1K-1K-1-1-1-1-1-26-26-26	07V
FMS-07W	1K-1K-1K-1K-1K-1K-1K-26-26-26	07W
FMS-07X	26-26-26-24-1-1-10-10	07X
FMS-07Y	1-1-1-26-10-26-26-10	07Y
FMS-07Z	1-10-10-10-26-26-26	07Z
FMS-07AB	1-1-1-1-1-1-1-26-26-26	7AB
FMS-07AC	10-10-10-9-26-26-26	7AC
FMS-07AD	26-26-9-10-10-10-26	7AD
FMS-07AE	1-1-26-26-1-1-26-10-9	7AE
FMS-07AF	26-26-26-1-24-1-10-10	7AF
FMS-07AG	10R-10R-10R-9R-26-26-26	7AG
FMS-07AH	26-26-26-1-13-13-13	7AH
FMS-07AJ	1K-1K-1K-1K-26-26-1K-1K-26-1K	7AJ
FMS-07AK	26-26-26-10-10-10-1	7AK
FMS-07AL	1W-1W-1W-1Y-1Y-1-1-26-26-26	7AL
FMS-07AP	2-2-16-26-26-26	7AP
FMS-07AQ	1-1-1-10-26-26-10-26	7AQ
FMS-07AS	11-11-11-9-26-26-26	7AS
FMS-08A	26-26-1-1-1-1-1-1-1-1	08A
FMS-08B	26-26-2-2-2-2	08B
FMS-08C	26-26-9-9-9-9-9-9-9	08C
FMS-08D	26-26-1-10-1-1-10-1	08D

Color Key: k: Black b: Blue g: Green e: Orange r: Red w: White n: Brown y: Yellow p: Purple

FMS 10 Pole Test Switches

Part Number	Arrangement	R19 Rack Code
FMS-08E	26-26-1-1-1-10-1-10	08E
FMS-08F	26-26-10-10-10-10	08F
FMS-08G	26-10-10-10-10-26	08G
FMS-08H	1K-1K-1K-1K-1K-26-26-1K-1K-1K	08H
FMS-08I	1K-1K-1K-1K-26-26-1K-1K-1K-1K	08I
FMS-08J	1K-26-26-1K-1K-1K-1K-1K-1K-1K	08J
FMS-08K	1K-1K-1K-1K-1K-26-26-10-1K	08K
FMS-08L	1K-1K-1K-26-26-10-1K-1K-1K	08L
FMS-08M	1K-1K-1K-1K-26-10-10-26	08M
FMS-08N	1K-1K-26-9-9-9-9-26-1K-1K	08N
FMS-08P	1K-1K-26-10-10-26-1K-1K	08P
FMS-08Q	1K-10-1K-26-26-1K-10-1K	08Q
FMS-08R	26-26-1K-1K-1K-10-10-1K	08R
FMS-08S	26-10-10-10-1K-1K-26	08S
FMS-08T	26-10-10-10-26-1K-1K	08T
FMS-08U	1K-26-9-10-10-10-26	08U
FMS-08V	9-9-9-9-26-26-9-9-9-9	08V
FMS-08W	26-9-9-9-9-9-9-9-26	08W
FMS-08X	1B-1B-1B-1B-26-26-1B-1B-1B-1B	08X
FMS-08Y	1K-1K-26-10R-10R-26-1K-1K	08Y
FMS-08Z	1K-10R-1K-26-26-1K-10R-1K	08Z
FMS-08AB	10-10-10-10-26-26	8AB
FMS-08AC	1-1-1-1-26-26-1-1-1-1	8AC
FMS-08AD	26-26-#1-9-10-10-10#	8AD
FMS-08AE	26-9-9-9-9-9-26-1K-1K	8AE
FMS-08AF	26-26-1-1K-1B-1B-1B-1B-1B-1B	8AF
FMS-08AG	26-26-1E-1E-1E-1E-1E-1E-1E-1E	8AG
FMS-08AH	26-26-10-10-10-1-1	8AH
FMS-08AI	1-1-1-24-26-26-1-1-1-24	8AI
FMS-08AJ	26-10R-10R-10R-10R-26	8AJ
FMS-08AK	26-26-1-1-1-1-1-1-1G-1G	8AK
FMS-08AL	10-10-10-2-26-26	8AL
FMS-08AM	26-26-1-1-10-10-10	8AM
FMS-08AN	26-26-9-9-9-#6-6-6-#-24	8AN
FMS-08AP	1K-1K-2K-1-1Y-1B-1W-26-26	8AP
FMS-08AQ	2K-2K-2K-2K-26-26	8AQ
FMS-08AR	1B-1B-1B-1B-1B-1B-1B-1B-26-26	8AR
FMS-08AS	10-10-1G-1-1-1-26-26	8AS
FMS-08AT	26-1-1-1Y-1Y-1Y-1Y-1Y-1Y-26	8AT
FMS-08AU	2K-2K-2K-1-1-26-26	8AU
FMS-08AV	10-10-10-1-1-26-26	8AV
FMS-08AW	26-26-1-1-1-1-10-10	8AW
FMS-08AX	1K-1K-1K-1K-26-26-1K-1K-1K-1	8AX
FMS-08AZ	1B-1B-1-1-#6-6-6-#-9-26-26	8AZ
FMS-08XY	1K-1-1-10-10-26-26-1	8XY
FMS-08BA	1K-1K-1K-1-1-1-1-1K-26-26	8BA
FMS-08BB	26-26-2-16-16	8BB
FMS-08BC	26-10-10B-10R-10E-26	8BC
FMS-08BD	10-10-10-26-26-2	8BD
FMS-08BE	26-10EK-10EK-10EK-10EK-26	8BE
FMS-08BF	10-10-10-26-26-1K-1K	8BF
FMS-08BG	1K-1K-1K-1K-1K-1K-1K-26-26	8BG

FMS 10 Pole Test Switches

Part Number	Arrangement	R19 Rack Code
FMS-08BH	10-10-26-26-10-10	8BH
FMS-08BI	26-26-1K-1K-1K-1K-1-1-1K	8BI
FMS-08BJ	1-1-1-1-1-1-1-1Y-26-26	8BJ
FMS-08BK	#10-10-10-10#-26-26	8BK
FMS-08BL	1-1-1-1-1-1-1-1-26-26	8BL
FMS-08BM	1-1-10-1-1-10-26-26	8BM
FMS-08BN	1-1Y-1B-1K-26-26-1-1Y-1B-1K	8BN
FMS-08BO	2K-2K-2K-10-26-26	8BO
FMS-08BP	6-6-6-9-1K-1K-1K-1K-26-26	8BP
FMS-08BQ	26-26-10R-10R-10R-10R	8BQ
FMS-08BR	26-10W-10W-10W-10W-26	8BR
FMS-08BS	1-1-1-1-6-24-6-24-26-26	8BS
FMS-08BT	10-10-10-26-26-1-1	8BT
FMS-08BU	#10-10-10#-24-24-26-26	8BU
FMS-08BV	#13R-13R-13R-1K-1K#-26-26	8BV
FMS-08BW	10-26-26-10-10-10	8BW
FMS-08BX	6-6-6-9-6-6-6-9-26-26	8BX
FMS-08BY	26-10-10-10-26-10	8BY
FMS-08BZ	10-26-26-2-2-2	8BZ
FMS-08CA	1-1-1-1W-26-26-1B-1B-1B-1W	8CA
FMS-08CB	1-1-1-1-#6-6-6-5#-26-26	8CB
FMS-08CC	13-13-13-13-26-26	8CC
FMS-08CE	10-10-10-26-26-10	8CE
FMS-08CF	10-10G-10R-26-26-1Y-1Y	8CF
FMS-08CH	1B-1B-1B-1B-1B-1B-26-26-1B-1B	8CH
FMS-08CI	1B-1B-1B-1B-1B-1B-26-26-1-1	8CI
FMS-08CJ	10-10-10-24-24-26-26	8CJ
FMS-08CK	1-1-1-1-26-1-1-1-1-26	8CK
FMS-08CL	26-1-1-1-1-1-1-1-1-26	8CL
FMS-08CM	1K-1K-1K-1K-26-1K-1K-26-1K-1K	8CM
FMS-08CN	9-9-9-9-1K-26-26-16	8CN
FMS-08CO	1Y-1G-1-1B-1Y-1G-1-1B-26-26	8CO
FMS-08CP	1-1-1-26-1-1-1-26-10	8CP
FMS-08CQ	16-10-10G-10R-10W-26	8CQ
FMS-08CR	#6-6W-6R-5G#-13-13-26-26	8CR
FMS-08CS	#13-13W-13R-13G#-26-26	8CS
FMS-08CT	#1K-1W-1-1G#2K-2K-26-26	8CT
FMS-08CU	13-#1K-1W-1-1G#-2K-26-26	8CU
FMS-08CV	#6-6W-6R-5G#-#6-6W-6R-5G#-26-26	8CV
FMS-08CX	1-1-1-1-26-26-1K-1K-1K-1K	8CX
FMS-09A	26-1-1-1-1-1-1-1-1-1	09A
FMS-09AB	10-10-10-9-26-1K-1K	9AB
FMS-09AC	26-10-10-10-10-1	9AC
FMS-09AD	1-1-26-10-10-10-24	9AD
FMS-09AE	1K-1K-1K-26-10-10-10	9AE
FMS-09AF	10R-10R-10R-9R-26-10R	9AF
FMS-09AG	1-1-1-10-1-1-10-26	9AG
FMS-09AH	1K-24-1K-10-10-10-26	9AH
FMS-09AI	1-1-1-1-24-1-1-1-24-26	9AI
FMS-09AJ	10-10-10-10-24-26	9AJ
FMS-09AK	1K-1K-1K-1K-1K-1K-1K-26-1K	9AK

Color Key: k: Black b: Blue g: Green e: Orange r: Red w: White n: Brown y: Yellow p: Purple

FMS Semiflush-Mounted Test Switches

FMS 10 Pole Test Switches

Part Number	Arrangement	R19 Rack Code
FMS-09AL	1-2-2-2-2-26	9AL
FMS-09AM	1-1-10-10-26-1-1-1	9AM
FMS-09AN	1-1W-26-1-1-1-#6-6-6-1K#	9AN
FMS-09AO	1-1-1-1W-1-26-1B-1B-1B-1B	9AO
FMS-09AP	10-10-10-1K-1K-1K-26	9AP
FMS-09AR	#10-10-10#-26-16K	9AR
FMS-09AS	1K-16K-26-1K-1K-1K-1K-1K	9AS
FMS-09AT	1K-#1K-1K-13#-26-1K-1K-1K-1K	9AT
FMS-09AU	13-13-13-9-9-9-26	9AU
FMS-09AV	10-10-10-1-1-1-26	9AV
FMS-09AW	9-9-9-9-1-1-1-1-1-26	9AW
FMS-09AY	#10-1K#-#10-1K#-#10-1K#-26	9AY
FMS-09AZ	9-9-9-9-1K-1K-26-16K	9AZ
FMS-09B	26-16-16-16	09B
FMS-09BA	10-10-10-1Y-1Y-1Y-26	9BA
FMS-09BB	10-10-10-9-26-10	9BB
FMS-09BC	10-10-9-26-10-10	9BC
FMS-09BD	10-10-9-26-1-1-1-1	9BD
FMS-09BE	1Y-1E-1E-10-10-10-26	9BE
FMS-09BF	1K-#1K-1K-13#-26-#1K-1K-1K#-1K	9BF
FMS-09BH	10-10-10-10-26-1	9BH
FMS-09BI	1K-1G-1-1W-26-1W-1W-1W-1B-1B	9BI
FMS-09BJ	26-10-9-10-10-10	9BJ
FMS-09C	26-9-9-9-9-9-9-9-9	09C
FMS-09D	26-1-10-1-10-1-10	09D
FMS-09E	26-1-1-1-10-10-10	09E
FMS-09F	1K-1K-1K-1K-26-1K-1K-1K-1K-1K	09F
FMS-09G	1K-1K-26-1K-1K-1K-1K-1K-1K-1K	09G
FMS-09H	1K-1K-1K-1K-1K-26-10-9-1K	09H
FMS-09I	1K-1K-1K-1K-1K-10-10-26	09I
FMS-09J	1K-1K-1K-1K-26-10-10-1K	09J
FMS-09K	1K-1K-26-10-10-10-1K	09K
FMS-09L	9-10-10-10-10-26	09L
FMS-09M	1-10-10-10-10-26	09M
FMS-09N	26-#1-1-1-#10-10-10#	09N
FMS-09P	16-10-10-10-26	09P
FMS-09Q	1B-1B-1B-1B-1B-1B-1B-1B-26	09Q
FMS-09R	26-16K-16K-16K	09R
FMS-09S	9-9-9-#6-6-6-6#-9-9-26	09S
FMS-09T	1-1-1-10-10-10-26	09T
FMS-09U	#10-10-10#-26-16	09U
FMS-09V	1-1K-1K-1K-1K-1K-1K-10-26	09V
FMS-09W	10-26-1-10-10-10	09W
FMS-09X	1-1G-1-26-10-10-10	09X
FMS-09Y	#1K-1K-1K-1K#-#6-6-6-6#-24-26	09Y
FMS-09Z	2-26-9-10-10-10	09Z
FMS-10A	1-1-1-1-1-1-1-1-1-1	10A
FMS-10A1	1K-1K-1K-1K-1K-1K-1K-1K-1K-1K	0A1
FMS-10A1A	10R-10R-1E-1E-1E-1E-1E-1E	A1A
FMS-10A1B	1E-1E-10E-1E-1E-1E-1E-10E	A1B
FMS-10A1C	1E-1E-1K-1K-1K-1K-1E-1E-1E-1E	A1C

FMS 10 Pole Test Switches

Part Number	Arrangement	R19 Rack Code
FMS-10A1D	1K-1K-1K-1K-1K-1E-1E-1E-1E-1E	A1D
FMS-10A1E	10E-1E-1E-10E-1E-1E-10E	A1E
FMS-10A2	1B-1B-1B-1B-10-10-10	0A2
FMS-10A3	10-1-1-1-1-1-1-1-1-1	0A3
FMS-10A4	1K-1Y-1K-1K-1K-1-1-1-1-1	0A4
FMS-10A5	1W-1K-1K-1K-1K-1K-1K-1K-1K-1K	0A5
FMS-10A6	1N-1N-1Y-1Y-1Y-1Y-1E-1E-10	0A6
FMS-10A7	1-1-1-1-#10#-#10#-#10#	0A7
FMS-10A9	10-10-10-1-1G-10	0A9
FMS-10AA	6-6-6-9-1-1-1-1-1K-1K	0AA
FMS-10AB	1-10-10-10-10-1	0AB
FMS-10AC	10-9-9-9-9-9-9-1-1	0AC
FMS-10AD	10-10-10-1K-1K-1K-1	0AD
FMS-10AE	#1-1-1-1-1#-1-1-1-1-1	0AE
FMS-10AF	1-1-1-10-10-1-1-1	0AF
FMS-10AG	10-1K-1K-1K-1K-1K-1K-1K-1	0AG
FMS-10AH	1E-1E-1E-1E-1E-1E-1E-1E-1E	0AH
FMS-10AI	10-1-1-1-1K-1K-1K-1K-1K	0AI
FMS-10AJ	1-1-1K-1K-1K-1K-1K-1K-1-1	0AJ
FMS-10AK	1-1K-1-1K-1K-1K-1K-1-1K-1	0AK
FMS-10AL	1E-1E-1-1-1-1-1K-1K-1K-1K	0AL
FMS-10AM	2-1-1-10-10-10	0AM
FMS-10AN	6-6-6-9/6-6-90-1K-1K	0AN
FMS-10AP	1K-1-1K-1-1K-1-1K-1K-1K-1K	0AP
FMS-10AQ	1-1-1-1E-1E-1E-1E-1E-1E-1E	0AQ
FMS-10AR	1B-1B-10-10-10-10G	0AR
FMS-10AS	1-1K-1B-1B-10-10-10	0AS
FMS-10AT	1E-1E-1E-1E-10-10-10	0AT
FMS-10AU	1-1K-10-10-10-10	0AU
FMS-10AV	1W-1B-1B-1E-1E-1E-1E-1E-1E	0AV
FMS-10AW	1W-1E-1E-1E-10-10-10	0AW
FMS-10AX	1G-1G-1G-1G-1G-1W-1W-1W-1W-1W	0AX
FMS-10AY	2K-2K-2K-#1K-1K-1K-1K#	0AY
FMS-10AZ	#1K-1K-1K-1K#-13-13-13	0AZ
FMS-10B	9-9-9-9-9-9-9-9-9-9	10B
FMS-10B1	10-1W-1K-1B-1B-1-1-1-1	0B1
FMS-10B2	1B-1B-1-1-1B-1B-1-1-1B-1B	0B2
FMS-10B3	1-1-1B-1B-1-1-1B-1B-1-1	0B3
FMS-10B4	10-1-1-1-1-1W-1K-1B-1B	0B4
FMS-10B5	1K-1-1K-1K-1K-1K-1K-1K-1K-1K	0B5
FMS-10B6	1K-1-1K-1K-1K-1-1K-1K-1K-1K	0B6
FMS-10B7	1-1-1-1-1-1-1-1-1-1K	0B7
FMS-10B8	1E-1E-1E-10-10-10-1E	0B8
FMS-10B9	#10-10-10#-1B-1B-2K	0B9
FMS-10BA	1B-1B-1B-1B-1B-1B-1B-1K-1K	0BA
FMS-10BC	1-13-1-13-1-13-1	0BC
FMS-10BD	1Y-1K-1K-1K-1K-1K-1K-2K	0BD
FMS-10BE	2K-1B-1B-1B-1B-1B-2K	0BE
FMS-10BF	1Y-1-1-1-1-1-1-1-1-1	0BF
FMS-10BG	1K-1W-10-10-10-2	0BG
FMS-10BH	1-1-1-1G-10-10-10	0BH
FMS-10BI	1W-1W-10-10-10-10	0BI

Color Key: k: Black b: Blue g: Green e: Orange r: Red w: White n: Brown y: Yellow p: Purple

FMS 10 Pole Test Switches

Part Number	Arrangement	R19 Rack Code
FMS-10BJ	1-1-1-1G-1Y-1B-1Y-1E-1E-1Y	OBJ
FMS-10BK	1W-1W-1-1-1Y-1B-1Y-1E-1E-1K	OBK
FMS-10BL	1W-1W-1E-1E-10-10-10	OBL
FMS-10BM	1K-1Y-1Y-1K-10-10-10	OBM
FMS-10BN	1W-1W-1Y-1E-10-10-10	OBN
FMS-10BO	2-2-2-2Y-2Y	OBO
FMS-10BP	2Y-2Y-2Y-2Y-2	OBP
FMS-10BQ	2-2-2W-2W-2BN	OBQ
FMS-10BR	2Y-2-2-2-2	OBR
FMS-10BS	2-2-2-2-2BN	OBS
FMS-10BT	2Y-2Y-2-2-2BN	OBT
FMS-10BU	1W-1W-1-1-1-1G-1K-1K-1K-1Y	OBU
FMS-10BV	1W-1W-1E-1E-1Y-1Y-1B-1B-1Y-1W	OBV
FMS-10BW	1W-1W-1Y-1K-1K-1K-1K-1K-1K-1K	OBW
FMS-10BX	1W-1Y-1Y-1E-10-10-10	OBX
FMS-10BY	1W-1W-1K-1K-1K-1K-1K-1K-1K-1K	OBY
FMS-10BZ	1K-1Y-1Y-1Y-10-10-10	OBZ
FMS-10C	1-10-1-10-1-10-1	10C
FMS-10C1	1K-10-1K-10-1K-10-1K	OC1
FMS-10C2	1B-1B-1B-1B-1-1-1B-1B-1B-1B	OC2
FMS-10C3	1-1-1B-1B-1B-1B-1-1-1B-1B	OC3
FMS-10C4	1B-1B-1-1-1B-1B-1-1-1-1	OC4
FMS-10C5	10R-10Y-10B-10R-10Y	OC5
FMS-10C6	10B-10R-10Y-10B-10R	OC6
FMS-10C7	10Y-10B-10R-10Y-10B	OC7
FMS-10C8	1K-1K-1K-1B-1B-1Y-1Y-1-1-1	OC8
FMS-10C9	1-1-1-1W-1K-1K-1K-1K-1K-1K	OC9
FMS-10CA	6-6-6-9-1-6-6-6-9-1	OCA
FMS-10CB	1K-1K-1K-1K-1E-1E-1E-1E-1E-1E	OCB
FMS-10CC	1-1Y-1B-1G-10-10-10	OCC
FMS-10CD	#1-1-10-1-10-1-10#	OCD
FMS-10CE	1E-1E-1E-1E-1E-1E-1E-1W-1W	OCE
FMS-10CF	10B-10B-10B-1K-1K-1K-1K	OCF
FMS-10CG	10Y-10Y-10Y-10G-1K-1K	OCG
FMS-10CH	1K-1K-1-1-10E-10E-10E	OCH
FMS-10CI	10Y-10Y-10Y-1K-1K-1K-1K	OCI
FMS-10CJ	1-1K-1B-10R-10-10B-1W	OCJ
FMS-10CK	1B-10R-1B-10R-1B-10R-1B	OCK
FMS-10CL	#1K-1K-1K-1K#-2K-2K-2K	OCL
FMS-10CM	#10-10-10#-1K-1K-1K-1K	OCM
FMS-10CN	#10#-1K-1K-1K-1K-1K-1K-2K	OCN
FMS-10CO	1-1K-1K-1K-1K-1K-1K-1-1	OCO
FMS-10CP	1K-1K-1K-1K-1K-1K-1K-10R-1K	OCP
FMS-10CQ	1W-1W-1Y-1B-10-10-10	OCQ
FMS-10CR	1K-1Y-1Y-1E-10-10-10	OCR
FMS-10CS	1-9-9-9-9-9-9-9-9-1	OCS
FMS-10CT	16-10-10-10-1	OCT
FMS-10CU	1B-1B-1G-1G-1W-1W-1Y-1Y-1Y-1Y	OCU
FMS-10CV	1W-1W-1Y-1Y-1Y-1Y-1Y-1Y-1Y-1Y	OCV
FMS-10CW	1Y-1Y-1Y-1Y-1K-1K-1-1-1-1	OCW
FMS-10CX	1K-1-1-1-1-1-1-1-1-1	OCX
FMS-10CY	10Y-10Y-10Y-10Y-10Y	OCY

FMS 10 Pole Test Switches

Part Number	Arrangement	R19 Rack Code
FMS-10CZ	1B-1B-1B-10Y-10Y-10Y-1B	OCZ
FMS-10D	1-1-1-1-10-10-10	10D
FMS-10D1	1-1-1-1G-1G-1G-1K-1K-1K-1W	OD1
FMS-10D2	1W-1K-1-1-1-1-1-1-1-1	OD2
FMS-10D3	1W-1K-1-1-10-10-10	OD3
FMS-10D4	1B-1W-1-1K-10B-10W-10R	OD4
FMS-10D5	10EK-10EK-10EK-2-2	OD5
FMS-10D6	1-1-1-1-1B-1B-1B-1B-1W-1K	OD6
FMS-10D7	1-1-10-1-1-1-1-1-1	OD7
FMS-10D8	1-1-1-1-10-10-1-1	OD8
FMS-10D9	1-1-1-1-10-1-1-1-1	OD9
FMS-10DA	1K-1K-1K-10Y-10Y-10Y-1K	ODA
FMS-10DB	1K-1K-1K-1K-1K-1K-1K-10Y-1K	ODB
FMS-10DC	1E-1E-1E-1E-1E-1E-1Y-1Y-1Y-1Y	ODC
FMS-10DD	10R-10R-10R-1E-1E-1E-1E	ODD
FMS-10DE	1K-1K-1K-1K-1B-1B-1B-1B-1B-1B	ODE
FMS-10DF	10R-10R-10R-1K-1K-1K-1K	ODF
FMS-10DG	1-1-1-1K-1K-1K-1K-1-1-1	ODG
FMS-10DH	10R-1K-1K-10-10-10	ODH
FMS-10DI	#10-10-10#-10-2K	ODI
FMS-10DJ	#1K-1K-1K-1K#-1-1-1-1-1-1	ODJ
FMS-10DK	1Y-1B-1B-1B-1B-1B-1B-2K	ODK
FMS-10DL	1B-1B-1B-10R-10R-10R-1B	ODL
FMS-10DM	1E-1W-1K-1K-1K-1K-1K-1K-1K-1K	ODM
FMS-10DN	1-1K-1K-10-10-10-1K	ODN
FMS-10DO	10B-10B-10B-10B-1W-1W	ODO
FMS-10DP	1Y-1Y-1Y-1Y-1Y-1Y-1-1-1K-1K	ODP
FMS-10DQ	1K-1K-1-1-1K-1K-1K-1K-1E-1E	ODQ
FMS-10DR	10-10-10-1E-1E-1E-1E	ODR
FMS-10DS	10-10-10-1-1K-1B-1B	ODS
FMS-10DT	1K-1K-1K-1K-1K-1K-10R-10R	ODT
FMS-10DU	1-1-1W-1K-1B-1B-1-1-1-1	ODU
FMS-10DV	1-1W-1W-1W-1W-1K-1K-1K-1K-1K	ODV
FMS-10DW	10W-10W-10W-1W-1W-1W-1W	ODW
FMS-10DX	10-9-9-9-9-9-9-9-9	ODX
FMS-10DY	9-9-9-9-1-1-1-1-1-1	ODY
FMS-10DZ	1-1-1-1-2K-#1K-1K-1K-1K#	ODZ
FMS-10E	1-1-1-10-10-10-1	10E
FMS-10E1	1K-1K-1K-10-10-10-1K	OE1
FMS-10E2	10-10-10-1-1-1-1	OE2
FMS-10E3	10-10-10-10-1-1	OE3
FMS-10E4	1K-10-10-10-10-1K	OE4
FMS-10E6	1-1K-1E-1E-10-10-10	OE6
FMS-10E7	1W-1B-1B-1E-1E-1E-1E-1-1K	OE7
FMS-10E9	2B-10-10-10-10	OE9
FMS-10EA	9-9-9-9-9-9-1K-1K-1K-1K	OEa
FMS-10EB	1-1-1-1-2K-1K-1K-1K-1K	OEb
FMS-10EC	1W-1K-1B-1B-1B-1B-1B-1-1	OEc
FMS-10ED	10-10-10-1-1-1B-1B	OEd
FMS-10EE	10B-10B-10B-1B-1B-1B-1B	OEe
FMS-10EF	10B-10B-10B-10B-1B-1B	OEf
FMS-10EG	1K-1K-1K-1-1K-1-1K-1-1K-1K	OEg

Color Key: k: Black b: Blue g: Green e: Orange r: Red w: White n: Brown y: Yellow p: Purple

FMS Semiflush-Mounted Test Switches

FMS 10 Pole Test Switches

Part Number	Arrangement	R19 Rack Code
FMS-10EH	6-6-6-9-10-6-6-6-9	0EH
FMS-10EJ	10R-10R-10R-10R-1K-1K	0EJ
FMS-10EL	1K-1K-10-10-10-10	0EL
FMS-10EM	#1K-1K-1K-1K-1K-1K-1K-1K-1K#	0EM
FMS-10EN	2-2-2-#1K-1K-1K-1K#	0EN
FMS-10EO	1-1-1-1-1-1-1-1-1-1Y	0EO
FMS-10EP	#1K-1K-1K-1K#-1B-1B-1B-1B-1B-1B	0EP
FMS-10EQ	1B-1B-1B-1-1-1-1-1-1-1	0EQ
FMS-10ER	#10-10-10-10-1K-1K#	0ER
FMS-10ES	#10-10-10-1K-1K-1K-1K#	0ES
FMS-10ET	1W-1K-1B-1B-1B-1B-1-1-1-1	0ET
FMS-10EU	1-10-10-1-10-10	0EU
FMS-10EV	1-10-10-1-1-1-1-1	0EV
FMS-10EW	1-1-1W-1K-1B-1B-1B-1B-1-1	0EW
FMS-10EX	1K-1K-1K-1K-1K-1K-1K-1K-2K	0EX
FMS-10EY	1-1W-1-1K-1K-1K-1K-1B-1K	0EY
FMS-10EZ	10-1-1K-1K-1-1K-1K-1K-1K	0EZ
FMS-10F	10-10-10-10-10	10F
FMS-10F1	1K-1K-1K-1K-1K-1-1-1-1-1K	0F1
FMS-10F2	1K-1-1-1-1K-1-1-1-1-1	0F2
FMS-10F3	1K-1K-1K-1K-1K-1-1K-1-1-1	0F3
FMS-10F4	1K-1-1-1K-1K-1K-1K-1K-1K	0F4
FMS-10F5	1K-1-1K-1K-1K-1K-1K-1K-1-1	0F5
FMS-10F6	1K-1-1K-1K-1K-1K-1K-1-1-1	0F6
FMS-10F8	#1-1-1-1-1-1-1-1-1-1#-1K-1K	0F8
FMS-10F9	#1-1-1-1#-1K-1K-1K-1K-1K-1K	0F9
FMS-10FA	1-1K-1K-1K-1K-1K-1K-1K-1K-1K	0FA
FMS-10FB	1K-1K-10-10-10-1-1	0FB
FMS-10FC	1K-1K-1K-1K-1K-1K-1K-1K-1-1	0FC
FMS-10FD	10-1B-10-10-10-1B	0FD
FMS-10FE	10E-10E-10E-10E-10E	0FE
FMS-10FF	10-10-10-1K-1K-1K-1K	0FF
FMS-10FG	1-1-1-1-1-1-1-1-10-1	0FG
FMS-10FH	1K-1K-1K-1K-1K-1K-1K-10-1	0FH
FMS-10FI	1-10-10-10-10-1K	0FI
FMS-10FJ	1K-1K-10-1K-1K-1K-1K-1K-1K	0FJ
FMS-10FK	1K-1K-1K-10-10-10-1	0FK
FMS-10FL	1-1K-1K-10-1K-1K-10-1K	0FL
FMS-10FM	1-10-10-10-1K-1K-1K	0FM
FMS-10FN	1B-1B-10-10-10-10	0FN
FMS-10FO	1N-1N-1-1-1-1-1-1-1-1	0FO
FMS-10FP	1-1-10-10-10-10	0FP
FMS-10FQ	# 1-1-1 #10-10-10-1	0FQ
FMS-10FR	1K-1K-1K-1K-1K-1K-10-1K-1K	0FR
FMS-10FS	1-1G-10-10-10-10	0FS
FMS-10FT	1B-1B-1B-1B-1B-1B-1K-1K-1W-1W	0FT
FMS-10FU	1B-1B-1B-1B-1K-1K-1K-1K-1W-1W	0FU
FMS-10FV	1K-1K-1K-1K-1-1-1K-1K-1K-1K	0FV
FMS-10FW	1K-1K-1K-1K-1K-1K-1K-1K-10R	0FW
FMS-10FX	1K-1K-1K-1K-1K-1K-1K-1K-1 - 1	0FX
FMS-10FY	1-1K-1K-1K-1K-1K-1K-1K-1K-1	0FY
FMS-10FZ	10-10-10-10-2	0FZ

FMS 10 Pole Test Switches

Part Number	Arrangement	R19 Rack Code
FMS-10G	10-10-10-10-1K-1K	10G
FMS-10G1	1-1-1-10-10-10-1Y	0G1
FMS-10G2	1-1-1-1-1-1-1E-1E-1Y-1Y	0G2
FMS-10G3	1-1-1-1-1-1-1Y-1Y-1Y-1Y	0G3
FMS-10G4	1-1-1-1-1E-1E-1E-1E-1Y-1Y	0G4
FMS-10G5	1-1-1-1-1W-1W-1E-1E-1E-1E	0G5
FMS-10G6	1B-1B-1-1-1-1-1-1Y-1Y	0G6
FMS-10G7	1B-1B-1-1-1-1-1E-1E-1Y-1Y	0G7
FMS-10G8	1N-1N-1-10-1E-1E-1E-1Y-1Y	0G8
FMS-10G9	1N-1N-1-1-1E-1E-1E-1Y-1Y-1Y	0G9
FMS-10GA	1-1-1-1-1-1-1K-1K-1K-1K	0GA
FMS-10GB	1K-1K-1K-1K-1K-1K-1K-1K-10	0GB
FMS-10GC	10-10-10-1B-1B-1B-1B	0GC
FMS-10GD	1E-1G-1-1K-1E-1K-1K-1K-1K-1K	0GD
FMS-10GE	1E-1G-1-1K-1K-1E-1G-1-1K-1K	0GE
FMS-10GF	1E-1G-1-10KE-10KG-10KR-1K	0GF
FMS-10GG	6R-6R-6R-9R-1K-1K-1K-1K-1K-1K	0GG
FMS-10GH	1E-1E-1E-10-10-10-1G	0GH
FMS-10GI	1-1-1-24-10-10-10	0GI
FMS-10GJ	1K-1-1K-1K-1-1K-1K-1-1K-1K	0GJ
FMS-10GK	1K-1K-1K-1K-10-10-10	0GK
FMS-10GL	1K-1K-1K-1K-1-1-1-1-1-1	0GL
FMS-10GM	1-1-1K-1K-1K-1K-1K-1K-1K-1K	0GM
FMS-10GN	1K-1K-1K-1K-1K-1K-1K-1B-1B	0GN
FMS-10GO	10R-10R-10R-1Y-1Y-1Y-1Y	0GO
FMS-10GP	1-1-1-1-1-1-1B-1B-1B-1B	0GP
FMS-10GQ	#6-6-6-24#-#6-6-6-24#-1-1	0GQ
FMS-10GR	1B-1B-1B-1B-1B-1B-1K-1K-1K-1K	0GR
FMS-10GS	1K-1K-10-10-10-10	0GS
FMS-10GT	1B-1B-1B-1B-1B-1B-1B-1B-1B	0GT
FMS-10GU	10-1B-1B-1B-1B-1B-1B-1B-1B	0GU
FMS-10GV	2K-10-10-10-10	0GV
FMS-10GW	1-1-13R-1-1K-1K-1K-1K-1K	0GW
FMS-10GX	1K-1B-1-1W-10-10BB-10RR	0GX
FMS-10GY	1K-1K-10R-10R-10R-10R	0GY
FMS-10GZ	1K-10-10-10-10-1	0GZ
FMS-10H	10-10-10-9-1K-1K-1K	10H
FMS-10H1	1N-1N-1-1-1W-1W-1E-1E-1E-1E	0H1
FMS-10H2	1N-1N-1E-10-1E-1Y-1Y-1Y-1Y	0H2
FMS-10H3	1N-1N-1E-1E-1E-1E-1E-1Y-1Y	0H3
FMS-10H4	1N-1N-1N-1N-1-1-1E-1E-1Y-1Y	0H4
FMS-10H5	1Y-1Y-1-1-1-1-1E-1E-1E-1E	0H5
FMS-10H6	1Y-1Y-1Y-10-10-10-1E	0H6
FMS-10H7	1Y-1Y-1Y-1Y-1Y-1Y-1E-1E-1E-1E	0H7
FMS-10H8	16-1K-1K-1K-1K-1K-1K-1K	0H8
FMS-10H9	#1-1-1-1-1-1#-1K-1K-1K-1K	0H9
FMS-10HA	6-6-6-24-1-1-1-1-1-1	0HA
FMS-10HB	6-6-6-24-10-10-10	0HB
FMS-10HC	#6-6-6-#1K-1-1-1-1-1-1	0HC
FMS-10HD	1K-1K-1K-10-10-10-9	0HD
FMS-10HE	2-2-2-2-2	0HE
FMS-10HF	1B-1B-6B-1B-1B-1B-6B-1B-1B	0HF

Color Key: k: Black b: Blue g: Green e: Orange r: Red w: White n: Brown y: Yellow p: Purple

FMS 10 Pole Test Switches

Part Number	Arrangement	R19 Rack Code
FMS-10HG	1-1-1-24-1B-1B-1B-1B-1B-1B	OHG
FMS-10HH	1K-1K-1K-1K-9-9-9-9-1K-1K	OHH
FMS-10HI	10-10-1-1-1-1-1-1	OHI
FMS-10HJ	#1-1-1-1-#-10-10-10	OHJ
FMS-10HK	1E-1E-10-10-10-10	OHK
FMS-10HL	10-10-10-10R-10R	OHL
FMS-10HM	1-10R-1Y-10Y-1B-10B-1K	OHM
FMS-10HN	1K-1K-1K-1K-1K-1K-1K-1K-#1K-1K#	OHN
FMS-10HO	10-#10#-1-1-1K-1K-1K-1K	OHO
FMS-10HP	#1-1-1-1-10-10-10#	OHP
FMS-10HQ	1-1-1-1-1-10-10-1	OHQ
FMS-10HR	1K-1K-10-10-10-1K-1K	OHR
FMS-10HS	1B-1B-1B-1B-1B-1B-1-1-1-1	OHS
FMS-10HT	#1-1-1-1-1-1-1-1-#-1-1-1	OHT
FMS-10HU	1-1-1-1-1-1-9-9-9-9	OHU
FMS-10HV	1-9-9-9-9-9-9-9-9-9	OHV
FMS-10HW	1-#10#-1-#10#-1-#10#-1	OHW
FMS-10HX	10R-10R-1K-1K-1K-1K-1K-1K	OHX
FMS-10HY	1K-1K-1K-1K-1K-1-1K-1-1K-1	OHY
FMS-10HZ	1K-1K-1K-1K-1K-1K-1-1-1-1	OHZ
FMS-10I	9-1K-1K-1K-1K-1K-1K-1K-1K-1K	10I
FMS-10I1	#1-1-1-1-1-1-1-1-#-1K-1K-1K	0I1
FMS-10I3	1-1-1B-1B-1B-1B-1B-1B-1W-1K	0I3
FMS-10I4	1-1-1-1-1Y-1Y-1Y-1Y-1Y-1Y	0I4
FMS-10I6	1K-1K-1K-1K-1K-1K-6-6-6-9	0I6
FMS-10I7	1K-1K-1K-1K-1K-1K-#1-1-1-1-#	0I7
FMS-10I8	1K-1K-1K-1K-#1-1-1-1-1-1-#	0I8
FMS-10I9	10-10-2-1K-1K-1K-1K	0I9
FMS-10IA	1-1W-1-1K-1-1-1K-1K-1-1	0IA
FMS-10IB	10-10-10-1-1K-1K-1K	0IB
FMS-10IC	1B-1B-1K-1B-1K-1B-1B-1K-1B-1K	0IC
FMS-10ID	1-1-1-1-1-1K-1-1K-1K-1B	0ID
FMS-10IE	1-1K-1-1K-1-1K-1K-1K-1-1	0IE
FMS-10IF	1-1W-1-1K-1-1-1K-1K-1K-1K	0IF
FMS-10IG	1-1W-1-1K-1K-1K-1K-1B-1K-1	0IG
FMS-10IH	1-1-1K-1-1K-1K-1K-1K-1K-1K	0IH
FMS-10IJ	1K-1K-1B-1K-1K-1K-1K-1K-1K-1K	0IJ
FMS-10IK	1K-1K-1K-1K-1K-1K-1K-16K	0IK
FMS-10IL	2K-1K-1K-1K-1K-1K-1K-2K	0IL
FMS-10IM	1-1-1-1-1-1-1-1K-1K-2K	0IM
FMS-10IN	1-1K-1Y-1Y-1B-1B-1B-1B-1B-1B	0IN
FMS-10IO	1-1-1-1-1K-1K-1K-1K-1B-1B	0IO
FMS-10IP	1-1-1-1-1Y-1Y-1W-1W-1-1K	0IP
FMS-10IQ	10-10-10-10-9-9	0IQ
FMS-10IR	1B-1B-1B-1B-1B-1B-1B-1-1K	0IR
FMS-10IS	1W-1K-1B-1B-1-1-1-1-1-1	0IS
FMS-10IT	1B-1B-1-1K-1K-1K-1K-1K-1	0IT
FMS-10IU	1-1K-1K-1K-1K-1K-1K-10-1	0IU
FMS-10IV	10-10-10-10-1W-1K	0IV
FMS-10IW	1B-1B-1-1-1-1-1-1-1-1	0IW
FMS-10IX	1K-1K-1K-1K-1K-1-1-1-1-1	0IX
FMS-10IY	1-1-1-10-10-10-24	0IY

FMS 10 Pole Test Switches

Part Number	Arrangement	R19 Rack Code
FMS-10IZ	1Y-1W-1B-24-10Y-10W-10B	0IZ
FMS-10J	1K-1K-1K-1K-1K-1K-10-1K	10J
FMS-10J1	10-10-#1-1-1-1-1-#-1K-1K	0J1
FMS-10J2	#1K-1K-1K-1K-1K-#-#1K-1K-1K-1K-#	0J2
FMS-10J3	1B-1B-1B-1B-1B-1W-1W-1W-1W-1W	0J3
FMS-10J4	10-10G-10R-1K-1G-1-1W	0J4
FMS-10J5	2K-1-1-1E-1E-1B-1B-1Y-1Y	0J5
FMS-10J6	10-10-10-1-1-1-1K	0J6
FMS-10J7	9-9-9-9-9-9-9-9-1-1	0J7
FMS-10J8	1B-1B-1B-1G-10-10-10	0J8
FMS-10J9	1Y-1Y-1Y-1G-10-10-10	0J9
FMS-10JA	24-1-1-1-10-10-10	0JA
FMS-10JB	10-10-10-1Y-1B-1B-1B	0JB
FMS-10JC	10-10-10-1E-1B-1B-1B	0JC
FMS-10JD	10-10-10-10W-1-1	0JD
FMS-10JE	10-10-10-10W-1E-1E	0JE
FMS-10JF	1B-1B-1B-1B-1G-1G-1E-1E-1-1	0JF
FMS-10JG	1-1K-1-1K-1-1K-1-1K-1-1K	0JG
FMS-10JH	1-1K-1K-1K-1K-1K-1K-1K-1E	0JH
FMS-10JI	10-10-10-1B-1B-1-1	0JI
FMS-10JJ	1-1-1-1-1K-1K-1K-1K-1K-1K	0JJ
FMS-10JK	10-1K-1K-1K-1K-1K-1K-1K-1K	0JK
FMS-10JL	16-16-10-10	0JL
FMS-10JM	1B-1G-1E-1-1W-1B-1G-1Y-10	0JM
FMS-10JN	1K-1K-1K-24-10-10-10	0JN
FMS-10JO	9-9-9-9-1-1-1-1-9-9	0JO
FMS-10JP	9-9-9-9-#-6-6-6-6-#9-9	0JP
FMS-10JQ	1-1K-1B-1B-1B-1B-1B-10G	0JQ
FMS-10JR	1W-1E-1E-1E-1E-1E-1E-1E-1E	0JR
FMS-10JS	1-1K-1B-1B-1B-1B-1B-1B-1B	0JS
FMS-10JT	1-1K-1B-1B-1B-1-1K-1B-1B-1B	0JT
FMS-10JU	1K-1K-1K-1K-1K-1K-1K-1-1-1	0JU
FMS-10JV	1B-10-10-10-10-1B	0JV
FMS-10JW	16-24-1-24-1E-1E-1G-1G	0JW
FMS-10JX	1-1K-1K-1K-1K-1K-1K-1E-1-1	0JX
FMS-10JY	10-9-9-1K-1K-1K-1K-1K-1K	0JY
FMS-10JZ	1-1K-1E-1E-1E-1E-1-1-10	0JZ
FMS-10K	1K-1K-1K-1K-1K-1K-9-10-1K	10K
FMS-10K1	1-1-1-1-1-1-1K-1K-1B-1B	0K1
FMS-10K2	1K-1K-1K-1K-1K-1K-1W-1W-10R	0K2
FMS-10K3	1-1E-1Y-24-10KW-10BW-10NW	0K3
FMS-10K4	6-6-6-9-1K-1K-1K-1K-1	0K4
FMS-10K5	10W-10W-10W-10W-10W	0K5
FMS-10K7	1N-1N-1N-1N-10N-10N-10N	0K7
FMS-10K8	10-1-1-10-10-10	0K8
FMS-10K9	10-1-1-1-1-1-1-10	0K9
FMS-10KA	1K-1K-1K-1K-1K-1K-1K-2	0KA
FMS-10KB	1-1-1-10-1-1-1-1-1	0KB
FMS-10KC	2K-1K-1K-1K-1K-1K-1K-1K	0KC
FMS-10KD	10-10-10-9-1-1-1	0KD
FMS-10KE	#1K-1K-1K-1K-#1-2-1-1-1	0KE
FMS-10KF	2-1-1-1-1-1-1-1-1	0KF

Color Key: k: Black b: Blue g: Green e: Orange r: Red w: White n: Brown y: Yellow p: Purple

FMS Semiflush-Mounted Test Switches

FMS 10 Pole Test Switches

Part Number	Arrangement	R19 Rack Code
FMS-10KG	2-1-1-1-1-1-1-2K	0KG
FMS-10KH	1-1-1W-1W-1-1E-1-1-1-1	0KH
FMS-10KI	2-2-1-1-1-1W-1W-1	0KI
FMS-10KJ	2-1B-1B-1-1W-1-1-1-1	0KJ
FMS-10KK	1-1W-1B-24-1K-1K-1-1W-1B-24	0KK
FMS-10KL	2-1-1W-1-1-1-1-1-1	0KL
FMS-10KM	2-1-1Y-1-1-1-1-1-1	0KM
FMS-10KN	1E-1-1W-1W-1W-1-1-1-1-1	0KN
FMS-10KO	2-1-1-1-1-1-1W-1W-1	0KO
FMS-10KP	#1-1-1-1-1-2K-1-1-1-1	0KP
FMS-10KQ	1-1KU-1KU-1KU-1KU-1K-1K-1K-1K	0KQ
FMS-10KR	1-1K-9-10-10-10-1K	0KR
FMS-10KS	1K-1-1-1-1-10-10-10	0KS
FMS-10KT	10R-10R-10R-9R-1-1-1	0KT
FMS-10KU	10R-10R-1-1-1-1-1-1	0KU
FMS-10KV	10R-10R-10R-1-1-1-1	0KV
FMS-10KW	1-16-10-10-10	0KW
FMS-10KX	#10-10-10-10-10#	0KX
FMS-10KY	1-1K-1E-1E-1E-1E-1E-1E-1E	0KY
FMS-10KZ	1-1K-1E-1E-1E-1E-1E-1E-1	0KZ
FMS-10L	1K-1K-1K-1K-1K-10-10-1K	10L
FMS-10L1	#10-10-10#-2-2K	0L1
FMS-10L2	1B-1B-1B-1B-2-2-2	0L2
FMS-10L3	1-1W-1B-1Y-24-1K-1K-1K-1K-1K	0L3
FMS-10L4	2Y-2KW-10E-10Y-10N	0L4
FMS-10L5	6-6-6-9-1N-1G-1N-1G-1N-1G	0L5
FMS-10L6	1P-1W-1Y-1Y-1Y-1P-1W-1-1-1	0L6
FMS-10L8	10-9-10-10-10-9	0L8
FMS-10L9	10-10-9-10-9-10	0L9
FMS-10LA	#6-6-6-9#-10#-2-1-1	0LA
FMS-10LB	1K-1K-1K-1K-1-1-1-1K-1K-1K	0LB
FMS-10LC	1-10-10-10-1-1-1	0LC
FMS-10LD	1-1-1-1-1-1-10-10	0LD
FMS-10LE	1K-1K-1K-1K-1K-1K-10-10	0LE
FMS-10LF	10-10-1-1-1-1B-1B-1B	0LF
FMS-10LG	10-9-9-9-9-9-9-1K-1K	0LG
FMS-10LH	10-1-24-1B-1B-1B-1B-1B-1B	0LH
FMS-10LI	1-1K-1-1-1K-1-1-1K-1-1	0LI
FMS-10LJ	1-1K-13E-1-1-1-1-1-1	0LJ
FMS-10LK	1-1-1-9-10-10-10	0LK
FMS-10LL	10-10W-10-10W-10	0LL
FMS-10LM	1-1K-13E-1-1K-13E-1-1	0LM
FMS-10LN	16-1-1-1-1-1-1-1	0LN
FMS-10LO	1Y-1-1-1-1-10-10-10	0LO
FMS-10LP	1K-1K-1K-10-1K-1K-1K-1K-1K	0LP
FMS-10LQ	1K-1-1W-1K-1-1W-1K-1-1W-1K	0LQ
FMS-10LR	1-1-1-1-10-10-10-1W	0LR
FMS-10LS	10-9-9-1-1-1-1-1-1	0LS
FMS-10LT	2-10-10-10-10	0LT
FMS-10LU	1B-1B-1B-1B-1K-1K-1K-1K-1K-1K	0LU
FMS-10LV	1-1-1K-10-10-10-9	0LV
FMS-10LW	2Y-2Y-2Y-2Y-2Y	0LW

FMS 10 Pole Test Switches

Part Number	Arrangement	R19 Rack Code
FMS-10LX	1W-1W-1W-10EK-10EK-10EK-1W	0LX
FMS-10LY	1-2-2-2-16	0LY
FMS-10LZ	1-10-10-10-16	0LZ
FMS-10M	1K-1K-1K-10-1K-1K-10-1K	10M
FMS-10M2	1K-1K-#1-1-1-1-1-1-1-1-1-1	0M2
FMS-10M3	10W-10W-10W-10W-1K-1K	0M3
FMS-10M4	10W-10W-10W-1K-1K-1K-1K	0M4
FMS-10M5	10R-10R-10R-10R-1E-1E	0M5
FMS-10M6	10-10-10-10-10R	0M6
FMS-10M7	10-10-10-10-1W-1W	0M7
FMS-10M8	10-10-1B-1B-1-1-2K	0M8
FMS-10M9	6W-6W-6W-9W-1K-1K-1K-1K-1-1	0M9
FMS-10MA	1-1-1-24-1-24-10-10 (#24 with jaws)	0MA
FMS-10MB	10-10-1B-1B-1B-1B-1B-1B	0MB
FMS-10MC	1-1-1-1-1-1-1-1-1B-1B	0MC
FMS-10MD	1K-24-1K-#10R-#10R-#10R-9W	0MD
FMS-10ME	1-10-1-1-1-1-10-1	0ME
FMS-10MF	10-10-10-1G-1-1-1	0MF
FMS-10MG	1K-1-1B-1B-1Y-1Y-1G-1-1-1	0MG
FMS-10MH	1N-1W-1B-1B-1G-1K-1Y-1Y-1K-1K	0MH
FMS-10MI	1K-1Y-1B-1B-1Y-1Y-1N-1W-1K-1K	0MI
FMS-10MJ	10-10-10-1N-1Y-1W-1W	0MJ
FMS-10MK	10-10-10-1N-1N-1W-1W	0MK
FMS-10ML	1K-1K-1K-1K-1K-1K-1K-1-1K-1	0ML
FMS-10MM	1-10KW-1E-10KW-1B-10GW-1Y	0MM
FMS-10MN	10-10-10-10-1B-1B	0MN
FMS-10MP	1-1-1-1-1K-1K-1K-1G-1-1K	0MP
FMS-10MQ	#10-10-10-#1K-1K-1K-1K#	0MQ
FMS-10MR	1Y-1K-1K-1K-1K-1K-1K-1-1-1	0MR
FMS-10MS	2K-1K-1Y-1B-1B-1K-1-1-1	0MS
FMS-10MT	#1K-1K-1K-1K-1K-1K-1K-1K-1K-1K	0MT
FMS-10MU	1Y-1K-1K-1K-1K-1K-1K-1K-1K-1	0MU
FMS-10MV	1K-10-10-10-1K-1K-1	0MV
FMS-10MW	1-1-1-1-1-1-1-1-1K-1K	0MW
FMS-10MX	1-2-2-2-2-1	0MX
FMS-10MY	1B-1B-1K-1K-1K-1K-1K-1K-1K-1K	0MY
FMS-10MZ	1-1-1-1-1-1-1-1K-1K-1K	0MZ
FMS-10N	1K-10-1K-1K-1K-1K-10-1K	10N
FMS-10N1	10-10N-10E-10Y-1-1	0N1
FMS-10N2	6-6N-6E-9G-6-6N-6E-9G-1-1	0N2
FMS-10N3	6-6N-6E-9G-1-1-1-1-1-1	0N3
FMS-10N4	1K-1E-1E-1E-6W-6W-6W-1W-2	0N4
FMS-10N5	1-1-1-1K-9-1K-9-1K-9-1K	0N5
FMS-10N6	#1-1-10-10-#1-1-1-10	0N6
FMS-10N7	10-10-1W-1K-1B-1B-1B-1B	0N7
FMS-10N8	2-2-16-1-90R	0N8
FMS-10N9	1B-1B-1K-1K-1K-1K-1K-1W-1W	0N9
FMS-10NA	1-1K-1K-1K-1K-1K-1K-10-1K	0NA
FMS-10NB	1N-1W-1B-1B-1G-1W-1Y-1Y-1W-1W	0NB
FMS-10NC	9-10-10-10-10-9	0NC
FMS-10ND	1K-1-1K-1-1K-1K-1K-1K-1K-1K	0ND
FMS-10NE	9-9-9-9-9-9-9-10	0NE

Color Key: k: Black b: Blue g: Green e: Orange r: Red w: White n: Brown y: Yellow p: Purple

FMS 10 Pole Test Switches

Part Number	Arrangement	R19 Rack Code
FMS-10NF	1K-1-1K-1-1K-1-1K-1-1K-1	ONF
FMS-10NG	#6-6-6-24-1#-#6-6-6-24-1#	ONG
FMS-10NH	1-1-1-10-10-10-9	ONH
FMS-10NI	10B-10B-1B-1B-1B-1B-1B-1B	ONI
FMS-10NJ	1B-1B-1B-1B-1-1-1-1-1-1	ONJ
FMS-10NK	1B-1-1-1-1-1-1-1-1-1	ONK
FMS-10NL	1-1-1-24-1-24-1-24-1-24	ONL
FMS-10NM	2K-2K-10-2K-1-1	ONM
FMS-10NP	2K-10-2K-2K-1-1	ONP
FMS-10NQ	1-1-1K-1K-1K-1K-1K-1K-1-1W	ONQ
FMS-10NR	1-1-1-1-1-1K-1K-1K-1K-1K	ONR
FMS-10NS	1B-1B-1G-1G-1W-1W-1W-1W-1W-1W	ONS
FMS-10NT	1Y-1Y-1Y-1Y-1Y-1Y-1Y-1Y-1G-1G	ONT
FMS-10NU	1G-1G-1G-1G-1G-1Y-1Y-1Y-1Y-1Y	ONU
FMS-10NV	1Y-1Y-1Y-1Y-1Y-1Y-1Y-1Y-1Y-1Y	ONV
FMS-10NW	1K-10-10-10-10-9	ONW
FMS-10NX	1K-1K-1K-1K-1-1-1K-10-1K	ONX
FMS-10NY	2B-2Y-1-1-1-1-1-1-1	ONY
FMS-10NZ	1K-10-10-10-1K-1K-1K	ONZ
FMS-10P	10-10-1K-1K-1K-1K-1K-1K	10P
FMS-10P3	#6-6-6-9#-1-1-1-1-1-1-1	OP3
FMS-10P5	2K-1B-1B-2-2-2	OP5
FMS-10P6	10B-10B-10B-10E-10E	OP6
FMS-10P7	10E-10G-10G-10G-1K-1K	OP7
FMS-10P9	10-10-10-1B-1B-1B-1	OP9
FMS-10PA	1K-1K-1K-1K-1K-1K-1K-10R-1K	OPA
FMS-10PB	1K-1K-1K-1K-1K-10R-10R-1K	OPB
FMS-10PC	1K-10R-1K-1K-1K-1K-10R-1K	OPC
FMS-10PD	1K-1K-1K-10R-10R-10R-1K	OPD
FMS-10PE	1K-10R-1K-10R-1K-10R-1K	OPE
FMS-10PF	1K-10R-10R-10R-10R-1K	OPF
FMS-10PG	10R-10R-10R-10R-10R	OPG
FMS-10PH	1K-1K-1K-1K-10R-10R-10R	OPH
FMS-10PJ	1-1-1K-10-10-10-1K	OPJ
FMS-10PK	9-9-9-9-9-9-9-9-1	OPK
FMS-10PL	9R-9R-9R-10-10-10-9	OPL
FMS-10PM	1-1-9-10-10-10-1	OPM
FMS-10PN	1-1-2-1-2-1-1-1	OPN
FMS-10PQ	1-1-1-1-1-1K-1-1-9-9	OPQ
FMS-10PR	10-10-10-16-1	OPR
FMS-10PS	1kU-1kU-1kU-1kU-10-10-10	OPS
FMS-10PT	1-1kU-1kU-1kU-1kU-1-1-1-1-1	OPT
FMS-10PU	1-1-1-1K-1K-1K-1K-1K-1K-1K	OPU
FMS-10PV	1-1-1-1-1-1-1-1-10	OPV
FMS-10PW	1-1-1Y-1Y-1K-1K-1K-1K-1K-1K	OPW
FMS-10PX	1-1-1-1Y-1Y-1K-1K-1K-1K-1K	OPX
FMS-10PY	1-10-10-10-10-1Y	OPY
FMS-10PZ	13-13-13-13-13	OPZ
FMS-10Q1	1-1-1-1-13-13-13	QQ1
FMS-10Q3	10-10-10-1W-1W-1-1	QQ3
FMS-10Q5	1K-1-1B-1W-10E-10N-10Y	QQ5
FMS-10Q6	1-1-1-1-1-1-1-1-1W-1K	QQ6

FMS 10 Pole Test Switches

Part Number	Arrangement	R19 Rack Code
FMS-10Q8	1-1-1-1B-1B-1B-1B-1B-1B	QQ8
FMS-10Q9	10R-10W-10B-24-24-24-24	QQ9
FMS-10QA	1-1Y-1K-1K-1K-1K-1K-1K-1K	QQA
FMS-10QB	10-10-10-10-1K-1	QQB
FMS-10QC	1-1-1-1-1-1Y-1K-1K-1K-1B	QQC
FMS-10QD	1-1-1K-1Y-1K-1B-1K-1K-2K	QQD
FMS-10QE	#10-10-10#-1K-1K-10	QQE
FMS-10QF	#10-10-10#-1K-1K-1K-1B	QQF
FMS-10QG	6-6-6-9-6-6-6-9-1K-1K	QQG
FMS-10QH	6-6-6-9-6-6-6-9-10	QQH
FMS-10QI	6-6-6-9-1K-1K-1K-1K-1K	QQI
FMS-10QJ	6-6-6-9-6-6-6-9-1-1	QQJ
FMS-10QK	6-6-6-9-1-1-1-1-1-1	QQK
FMS-10QL	1-1-1-1-1-1-10-1-1	QQL
FMS-10QM	#6-6-6#9-1-1-1-1-1	QQM
FMS-10QN	#6-6-6-#9-#6-6-6-#9-1-1	QQN
FMS-10QP	1G-1-1W-1K-10G-10R-10W	QQP
FMS-10QQ	1-1K-1K-10-10-10-9	QQQ
FMS-10QR	1-10-10-10-10-9	QQR
FMS-10QS	1Y-1Y-1Y-1Y-10-10-10	QQS
FMS-10QT	1B-1B-1B-24-10-10-10	QQT
FMS-10QU	1-1B-1K-1K-1K-24-#6-6-6-5#	QQU
FMS-10QV	1W-1W-1W-1W-10-10-10	QQV
FMS-10QW	10E-10E-10E-10B-10B	QQW
FMS-10QX	10B-1-1K-1K-1K-1-1K-10Y	QQX
FMS-10QY	10Y-10Y-10G-10G-10G	QQY
FMS-10QZ	1-1-1-1-2-2-2	QQZ
FMS-10R	1K-1K-9-10-10-10-1K	10R
FMS-10R1	10KG-10BG-10NG-1K-1K-1K-1K	OR1
FMS-10R2	1-1E-1Y-24-1E-24-1K-1K-1K-1K	OR2
FMS-10R3	10KG-10BG-10NG-10WG-1K-1K	OR3
FMS-10R4	1-1E-1Y-24-1W-24-1K-1K-1K-1K	OR4
FMS-10R5	1-1-1-1-1B-1B-1W-1K-10	OR5
FMS-10R6	1-1E-1Y-24-1W-1W-1K-1K-1K-1K	OR6
FMS-10R7	1-1-1-1-1-1-1W-1B-1B-1B	OR7
FMS-10R8	1-1-1-24-1B-1-1-1-24-1B	OR8
FMS-10R9	1E-1E-1-1-10-10-10	OR9
FMS-10RA	10-10-10-1-16	ORA
FMS-10RB	2-2-2-1-16	ORB
FMS-10RC	9-9-9-9-9-9-9-9-1K-1K	ORC
FMS-10RD	24-1-1-9-9-24-1-1-9-9	ORD
FMS-10RE	1-10-10-1-1-10-1	ORE
FMS-10RF	1-1K-1K-1K-10-10-10	ORF
FMS-10RG	1W-1W-1W-#10EK#-#10EK#-#10EK#-1W	ORG
FMS-10RH	1Y-1Y-1Y-1Y-1Y-1Y-#6-6-6#-9	ORH
FMS-10RI	1B-1B-#6-6-6#-9-#6-6-6#-9	ORI
FMS-10RJ	1-1-1-1-1-1Y-1Y-1Y-1Y-1Y	ORJ
FMS-10RK	#6-6-6#-9-#6-6-6#-9-10	ORK
FMS-10RL	1B-1B-1-1-1-1Y-1Y-1Y-1Y	ORL
FMS-10RM	1B-1B-1-1-10-10-10	ORM
FMS-10RN	1B-1B-1-1Y-1Y-1Y-#6-6-6#-9	ORN
FMS-10RO	1B-1B-1-1-1Y-1Y-1Y-1Y-1Y	ORO

Color Key: k: Black b: Blue g: Green e: Orange r: Red w: White n: Brown y: Yellow p: Purple

FMS Semiflush-Mounted Test Switches

FMS 10 Pole Test Switches

Part Number	Arrangement	R19 Rack Code
FMS-10RP	1B-1Y-1Y-1Y-10-10-10	ORP
FMS-10RQ	1-1-1-1-1-1-1kU-1kU-1kU-1kU-1	ORQ
FMS-10RR	1-10-10-10-1N-1N-1N	ORR
FMS-10RS	2K-1B-1B-1B-1B-1B-1B-1B-1B	ORS
FMS-10RT	1-1-1-1-1-1-1-1-1-1Y	ORT
FMS-10RU	10-10-9-9-9-9-1K-1K	ORU
FMS-10RV	1E-1E-1E-1E-1E-1Y-1Y-1Y-1Y-1Y	ORV
FMS-10RW	1Y-1Y-1Y-1Y-1Y-1Y-1Y-1-1-1	ORW
FMS-10RX	#1K-1K-1K-1K#-#6-6-6-6-24-1K	ORX
FMS-10RY	2K-#1K-1K-1K-1K#-2K-2K	ORY
FMS-10RZ	1K-1K-1-1-1K-1K-1K-1K-1K	ORZ
FMS-10S	1K-9-9-9-9-9-9-9-9-1K	10S
FMS-10S1	1K-1K-1K-1K-1-1G-1-1K-1K-1K	OS1
FMS-10S2	10-10W-10B-1-1-1-1	OS2
FMS-10S3	10-10W-10B-10-10	OS3
FMS-10S5	1K-1K-1K-1K-10W-10W-10W	OS5
FMS-10S6	1-1-1-10-10-10-1G	OS6
FMS-10S7	#10#-#10#-#10#-1-1-1-1	OS7
FMS-10S8	#10-1-1-1-1-1-1-1-1#	OS8
FMS-10SA	1K-1K-1-1-1-1-1K-1K-1K-1K	OSA
FMS-10SB	1K-1K-1K-1K-1-1-1-1-1K-1K	OSB
FMS-10SC	10-10-10-1Y-1Y-1Y-1Y	OSC
FMS-10SD	1K-1K-1K-1K-1K-1K-1K-1-1-1K	OSD
FMS-10SE	1B-1B-1B-10-10-10-1K	OSE
FMS-10SF	1K-1K-1B-1B-1K-1K-1K-1K-1K	OSF
FMS-10SG	1-1-1-1-1K-1K-1-1-1-1K	OSG
FMS-10SH	1-1-1K-1K-1-1-1-1K-1K-1K	OSH
FMS-10SI	10-1-10-1-1-1-1-1	OSI
FMS-10SJ	#6-6-6-6-24#-#6-6-6-6-24#	OSJ
FMS-10SK	2K-2K-2K-2K-2K	OSK
FMS-10SL	1-1-1K-1K-1K-1K-1K-1K-1Y-1K	OSL
FMS-10SM	10-10R-10B-1K-1-1B-1K	OSM
FMS-10SN	1N-1N-1N-10-10-10-1	OSN
FMS-10SO	#10#-#10#-#10#-#10#-#10#	OSO
FMS-10SP	6-6-6-9-6-6-6-9-1K-1	OSP
FMS-10SQ	1G-1G-1G-1G-1G-1G-1G-1G-1G	OSQ
FMS-10SR	1W-1W-1W-1W-1W-1W-1W-1W-1W	OSR
FMS-10SS	1B-1B-1W-1W-1W-1W-1W-1W-1W	OSS
FMS-10ST	1W-1W-1Y-1Y-1Y-1Y-1Y-1Y-1G-1G	OST
FMS-10SU	1B-1B-1B-10-10-10-1	OSU
FMS-10SV	1K-1K-1K-1K-1K-1K-1K-16	OSV
FMS-10SW	1-24-1-24-1B-1B-1B-1B-1B-1B	OSW
FMS-10SX	1K-1-1-1-1-1K-1K-1K-1K-1K	OSX
FMS-10SY	1-1-1-1-1-1Y-1Y-1Y-1K-1W	OSY
FMS-10SZ	10-10-10-9-10-9	OSZ
FMS-10T	9-9-9-9-9-9-9-9-1K	10T
FMS-10T1	1B-1B-1B-1B-1B-1Y-1Y-1Y-1Y	OT1
FMS-10T2	1K-1K-1K-10Y-10Y-10Y-1	OT2
FMS-10T3	#10-10-10-#-1K-1-1-1	OT3
FMS-10T4	1-1-1-1-1-1-1E-1-1-1	OT4
FMS-10T5	1-10R-1-10R-1-10R-1	OT5
FMS-10T6	1K-24-1K-24-1K-1K-1K-1K-1K	OT6

FMS 10 Pole Test Switches

Part Number	Arrangement	R19 Rack Code
FMS-10T7	1B-1B-1B-1B-1B-1W-1W-1W-1W	OT7
FMS-10T8	1W-1K-1K-1K-10B-10W-10R	OT8
FMS-10T9	1K-10-10B-10W-10R-1K	OT9
FMS-10TA	1K-1K-1-1-1-1B-1-1-1-1	OTA
FMS-10TB	1-1B-1-10-10-10-1	OTB
FMS-10TC	1K-1K-1K-1K-1-1-1-1B-1-1	OTC
FMS-10TD	1K-1K-1-1-1B-1-1-1-1-1	OTD
FMS-10TE	2K-2K-#1K-1K-1K-1K#-2K	OTE
FMS-10TF	2RK-2RK-2RK-2RK-2RK	OTF
FMS-10TG	10-10-1-1K-1-1K-1-1K	OTG
FMS-10TH	10-10-10-1K-1K-1-1	OTH
FMS-10TI	1K-1K-1K-1K-1K-1K-1K-1-1K-1	OTI
FMS-10TJ	1K-1B-1-1W-10KW-10YW-10EW	OTJ
FMS-10TK	16-1-10-10-10	OTK
FMS-10TL	10-10-10-1W-1W-1-1K	OTL
FMS-10TM	#1-1-1-1-1-1-1-1-1-1#	OTM
FMS-10TN	1Y-1Y-1Y-10-10-10-1Y	OTN
FMS-10TO	1-1-1-1W-10-10-10	OTO
FMS-10TP	1-1-1-1-1-1-10R-10R	OTP
FMS-10TQ	1E-1Y-1K-1K-1K-1K-1K-1K-1K	OTQ
FMS-10TR	1B-1B-1Y-1Y-1-1-1Y-1Y-1K-1K	OTR
FMS-10TS	1-1-1-1-1B-1B-1G-1G-1G-1G	OTS
FMS-10TT	1Y-1Y-1Y-1Y-1G-1G-1Y-1Y-1G-1G	OTT
FMS-10TU	1W-1W-1Y-1Y-1Y-1Y-1G-1Y-1Y-1G	OTU
FMS-10TV	1K-1K-1K-1K-1K-1K-10R-1K-1K	OTV
FMS-10TW	6-6-6-9-1-1-1-1-1B-1B	OTW
FMS-10TX	10-1W-1K-1B-1B-1B-1B-1-1	OTX
FMS-10TY	10-1B-1B-1-1-1-1-1-1	OTY
FMS-10TZ	1W-1K-1B-1B-1B-1B-1B-1B-1B	OTZ
FMS-10U	10-10-10-2-2	10U
FMS-10U1	2B-1K-1K-1-1-1-1K-1K-1K	OU1
FMS-10U2	1K-1K-1K-1K-16K-16K	OU2
FMS-10U3	2K-2K-2K-1-1-1-1	OU3
FMS-10U4	1-1W-1N-1N-1N-1N-#6-6-6-1K#	OU4
FMS-10U5	1E-1E-1E-1E-1E-1E-1K-1-1B	OU5
FMS-10U6	1E-1E-10-10R-10B-1-1K	OU6
FMS-10U7	1E-10-10R-10B-1K-1-1B	OU7
FMS-10U8	1B-1B-1-1-1B-1B-1W-1K-1W-1K	OU8
FMS-10U9	9R-9R-9R-9R-1K-1K-1K-1K-8-8	OU9
FMS-10UA	10-1B-1B-1B-1B-1B-1-1	OUA
FMS-10UB	1-1-1B-1B-1-1-1-1-1-1	OUB
FMS-10UC	1-1-1W-1K-1B-1B-1-1-1B-1B	OUC
FMS-10UD	1-1-1-1-1-1-10R-1-1	OUD
FMS-10UE	1B-1B-1B-10R-10R-10R-1K	OUE
FMS-10UF	1K-1K-1K-1-1K-1K-1K-1K-1K	OUF
FMS-10UG	10-10-10-1-1-1-1E	OUG
FMS-10UH	1-1-1-1-1K-1K-#1K-1K-1K-1K#	OUH
FMS-10UI	1-1-1-1-1-1-#1K-1K-1K-1K#	OUI
FMS-10UJ	1Y-1Y-1Y-1Y-10B-10B-10B	OUJ
FMS-10UK	1Y-1Y-1K-1K-1K-1K-1K-1K-1K	OUK
FMS-10UL	10-1B-1B-1B-1B-1B-1W-1K	OUL
FMS-10UM	1-10-1-10-1-1-1-1	OUM

Color Key: k: Black b: Blue g: Green e: Orange r: Red w: White n: Brown y: Yellow p: Purple

FMS 10 Pole Test Switches

Part Number	Arrangement	R19 Rack Code
FMS-10UN	10EK-10EK-10EK-10EK-10EK	OUN
FMS-10UO	1W-10-10-10-10-1W	OUO
FMS-10UP	1W-1W-1W-10-10-10-1W	OUP
FMS-10UQ	#1K-1K-1K-1K-#10-10-10#	OUQ
FMS-10UR	#1K-6-6-9-6-6-9-6-9#	OUR
FMS-10US	#6-6-6-6-9#-#6-6-6-6-9#	OUS
FMS-10UT	2-2K-2K-2K-2K	OUT
FMS-10UV	2K-2K-2K-#6-6-6-5#	OUV
FMS-10UW	10-10-9-9-9-9-9-9	OUW
FMS-10UX	1-1W-10-10-10-10	OUX
FMS-10UY	1-1W-1-1W-10-10-10	OUY
FMS-10UZ	10-10-10-1-1-10	OUZ
FMS-10V	1B-1B-1B-10-10-10-1B	10V
FMS-10V1	10R-10W-10B-1-1W-1B-1K	OV1
FMS-10V2	1E-1-1-1-10-10-10	OV2
FMS-10V3	10R-10W-10B-10-10	OV3
FMS-10V4	1-1-1-9W-10-10-10	OV4
FMS-10V5	10-10-10-#1-1-1-1#	OV5
FMS-10V6	1K-1K-1K-9W-10-10-10	OV6
FMS-10V7	13-13G-13R-1W-1W-1W-1W	OV7
FMS-10V8	2K-1-1-1-1-1-1-1K-1K	OV8
FMS-10V9	1E-1B-1Y-10R-10G-10-1W	OV9
FMS-10VA	1B-10-1B-10-1B-10-1B	OVA
FMS-10VB	1-1K-1K-1K-1K-1K-1K-1-1-1	OVB
FMS-10VC	1B-1B-1B-1B-1-1-1-1-1W-1K	OVC
FMS-10VD	1B-1B-1B-1B-1-1-1-1-1B-1B	OVD
FMS-10VE	1W-1W-1-1-1Y-1B-1Y-1E-1E-1Y	OVE
FMS-10VF	2-1K-1K-10-10-10	OVF
FMS-10VG	1-1Y-1G-10-10E-10-1	OVG
FMS-10VH	1K-10-10-1K-1K-1K-1K-1K	OVH
FMS-10VI	1K-1K-1K-1-1-1-1-1-1-1K	OVI
FMS-10VJ	#10-10-10#-#1-1-1-1-1#	OVJ
FMS-10VK	10-1K-1K-1K-1K-1K-1K-10	OVK
FMS-10VM	1-1-1-1-1K-1K-1-1-1-1	OVM
FMS-10VN	1K-1K-1-1-1-1-1-1-1K-1K	OVN
FMS-10VO	1-1Y-1B-1E-1K-1K-1K-1K-1K	OVO
FMS-10VP	6-6G-6N-9E-6-6G-6N-9E-1K-1K	OVP
FMS-10VQ	6-6G-6N-9E-1K-1K-1K-1K-1K	OVQ
FMS-10VR	10-10G-10N-10E-10	OVR
FMS-10VS	2-1-9-9-9-9-9-9-9	OVS
FMS-10VT	1P-1P-1P-1P-1P-1K-1-1Y-1B-1E	OVT
FMS-10VU	2-2-1K-1K-1K-1K-10	OVU
FMS-10VW	2W-2W-2W-2W-2W	OVW
FMS-10VV	1N-1N-1N-1N-10-10R-10B	OVV
FMS-10VX	1-1K-1E-1E-1E-1E-1E-1E-1W	OVX
FMS-10VY	16K-10-10-10-1K	OVY
FMS-10VZ	16K-1K-1K-1K-1K-1K-1K	OVZ
FMS-10W	90-90-90-90-90	10W
FMS-10W1	10B-10B-10B-10G-10G	OW1
FMS-10W2	10G-10E-10E-10E-10Y	OW2
FMS-10W3	10Y-10Y-1-1-1-1-1-1	OW3
FMS-10W5	#1-1-1-1-#-#1-1-1-1-#-2	OW5

FMS 10 Pole Test Switches

Part Number	Arrangement	R19 Rack Code
FMS-10W6	2-2-2-2-1-1	OW6
FMS-10W7	2-16-16-2	OW7
FMS-10W8	10-1B-1B-1B-1B-1B-1Y-1Y	OW8
FMS-10W9	1K-1K-1K-1K-16-16	OW9
FMS-10WA	1-1K-1K-1K-10E-10E-10E	OWA
FMS-10WB	1-1K-1-1K-1-1K-1-1K-1K	OWB
FMS-10WC	1-1K-1B-1B-1E-1E-1E-1E-1W	OWC
FMS-10WD	10-10-10-10-1Y-1Y	OWD
FMS-10WE	1-1-1-1-1K-10B-1K-1K-1K	OWE
FMS-10WF	10-10-10-1-1-1-1B	OWF
FMS-10WG	1-1-1-1G-10B-10E-10	OWG
FMS-10WH	10-10-10-10-1-1K	OWH
FMS-10WI	10B-10Y-10Y-10Y-1K-1K	OWI
FMS-10WJ	10-10-10-9-10-1	OWJ
FMS-10WK	10-10-10-9-10-1K	OWK
FMS-10WL	1K-1K-1K-1K-1-1K-1-1-1-1	OWL
FMS-10WM	1K-1K-1-10-10-10-1	OWM
FMS-10WN	1K-1K-1-1-1-1K-1K-1-1-1	OWN
FMS-10WO	1K-1K-1K-1K-1-1K-1K-1K-1	OWO
FMS-10WP	16-10-10-10-24	OWP
FMS-10WQ	1K-1K-1K-1K-1K-2-2	OWQ
FMS-10WR	10-10-1Y-1Y-1Y-1Y-1Y-1Y	OWR
FMS-10WS	6-6-6-9-1-1-1-1K-1K-1K	OWS
FMS-10WT	1K-1K-1K-1K-1K-9-9-9-9	OWT
FMS-10WU	1K-1-1B-1W-10-10R-10B	OWU
FMS-10WV	2RK-2-2-2-2	OWV
FMS-10WW	1E-1W-1W-1W-1B-1K-1K-1G-1Y-1N	OWW
FMS-10WX	1-1-1Y-1E-1-1-1Y-1-1-1K	OWX
FMS-10WY	9-9-9-9-1K-1K-1K-1K-1	OWY
FMS-10WZ	1W-16B-10R-10R-10R	OWZ
FMS-10X	16K-16K-2-2	10X
FMS-10X1	1Y-1Y-1Y-1Y-1W-1W-1W-1W-1W	OX1
FMS-10X2	1Y-1Y-1Y-1Y-1Y-1Y-1W-1W-1W-1W	OX2
FMS-10X3	1K-1K-1K-1K-2-2-2	OX3
FMS-10X4	2K-1Y-1Y-1Y-1Y-1Y-1B-1B	OX4
FMS-10X5	1-1-1K-1K-1K-1K-1K-1B-1B	OX5
FMS-10X7	1N-1N-1N-1N-1N-1N-1N-1N-1N	OX7
FMS-10X8	1-1-1-10W-10W-10W-1	OX8
FMX-10X9	1-1G-1Y-1G-1B-1G-1-1G-1Y-1G	OX9
FMS-10XA	1-1K-1-1K-1-1K-1K-1K-1K	OXA
FMS-10XB	1-1K-1-1K-1K-1K-1K-1K-1K	OXB
FMS-10XC	1-1-1-10-10-10-1K	OXC
FMS-10XD	16-16-2-2	OXD
FMS-10XE	1K-1K-1K-1-1-1-1-1-1-1	OXE
FMS-10XF	10G-10G-1K-1K-1K-1K-1K	OXF
FMS-10XG	10E-10E-10E-1K-1K-1K-1K	OXG
FMS-10XH	10B-10Y-10Y-10Y-10G	OXH
FMS-10XI	1-1-1-1-1B-1B-1B-1B-1B	OXI
FMS-10XJ	10-10G-10R-10W-1Y-1Y	OXJ
FMS-10XK	1K-1G-1-1W-1B-1B-1B-1B-1B	OXK
FMS-10XL	1W-1W-1W-1W-1W/6W-1W/6W-1W/1W	OXL
FMS-10XM	1G-1G-1Y-1Y-1E-1E-1W-1W-1B-1B	OXM

Color Key: k: Black b: Blue g: Green e: Orange r: Red w: White n: Brown y: Yellow p: Purple

FMS Semiflush-Mounted Test Switches

FMS 10 Pole Test Switches

Part Number	Arrangement	R19 Rack Code
FMS-10XN	10-1K-1K-1K-1K-1K-1-1	OXN
FMS-10XO	10R-10W-10B-24-24-10	OXO
FMS-10XP	1-1W-1B-24-10R-10W-10B	OXP
FMS-10XQ	1-1W-1B-1Y-1K-1K-1K-1K-1K	OXQ
FMS-10XR	(6W-24)-(6W-24)-(6W-24)-1W-1W-1W-1W	OXR
FMS-10XS	1-1-1-1-1W-1W-1W-1W-1W-1W	OXS
FMS-10XT	(6W-24)-(6W-24)-1W-1W-1W-1W-1W-1W	OXT
FMS-10XU	10-10-10-9-9-9-9	OXU
FMS-10XV	1E-1E-10-10-10-1K-1K	OXV
FMS-10XW	6-24/6-24/6-24/1K-1K-1K-1K	OXW
FMS-10XY	1K-1K-1K-1K-1K-1K-1K-1K/6/24	OXY
FMS-10XZ	1K-10-10-1K-1K-10-1K	OXZ
FMS-10Y	9-9-9-10-10-10-9	10Y
FMS-10Y1	1B-1G-1-1G-1Y-1G-1B-1G-1-1G	OY1
FMS-10Y2	1Y-1G-1B-1G-10-10-10	OY2
FMS-10Y3	10-10-10-1-1K-1-1K	OY3
FMS-10Y4	1B-1G-10-10-10-10	OY4
FMS-10Y5	1-1K-1-1K-1-1K-10-10	OY5
FMS-10Y6	1K-10-10-10-16	OY6
FMS-10Y7	1K-1K-10-10-10-2	OY7
FMS-10Y9	1K-1K-2-2-2-2	OY9
FMS-10YA	1W-1W-1W-1W-10EK-10EK-10EK	OYA
FMS-10YB	1K-1K-1K-1K-10R-10W-10B	OYB
FMS-10YC	1-1W-1-1-1-24-#6-6-6-1K#	OYC
FMS-10YD	1W-1B-1K-1K-1K-1K-1K-1K-1K	OYD
FMS-10YE	2-1K-1K-1K-1K-1K-1K-1K-1K	OYE
FMS-10YF	1-1-1K-1K-10-10-10	OYF
FMS-10YG	#10-10-10#-2K-2K	OYG
FMS-10YH	1-10-1-10-1-10-1W	OYH
FMS-10YI	16-2-1-1-1-1-1	OYI
FMS-10YJ	1-1-1-2K-1K-1K-1K-1K-1K	OYJ
FMS-10YK	6-6-6-6-24-6-6-6-6-24	OYK
FMS-10YL	#10-10-10#-1B-1B-1Y-1K	OYL
FMS-10YM	#10-10-10#-1-1-1-1	OYM
FMS-10YN	1-10-1-10-1-10-1W	OYN
FMS-10YO	1-1-10-10-10-1-1	OYO
FMS-10YP	10-1K-1W-1B-1B-1B-1B-1-1	OYP
FMS-10YQ	1K-1W-1B-1B-1B-1B-1-1-1-1	OYQ
FMS-10YR	10-1K-1W-1B-1B-1-1-1-1	OYR
FMS-10YS	1-1-1B-1B-1B-1B-1-1-1-1	OYS

FMS 10 Pole Test Switches

Part Number	Arrangement	R19 Rack Code
FMS-10YT	10-10-10-1W-1K-1-1	OYT
FMS-10YU	1-1-1-1-1B-1B-1B-1B-1-1	OYU
FMS-10YV	2-2-1K-1K-1K-1K-1K-1K	OYV
FMS-10YW	1B-1B-1G-1G-1G-1G-1G-1W-1W	OYW
FMS-10YX	1B-1B-1B-1B-1B-1-1-1-1-1	OYX
FMS-10YY	1W-1W-1W-1W-1W-1W-1-1-1-1	OYY
FMS-10YZ	#10-10#-1-1-1-1-1-1	OYZ
FMS-10Z2	1E-1E-1E-1E-1E-1E-1E-1K-1K	OZ1
FMS-10Z3	1-1-1-1K-10-10-10	OZ3
FMS-10Z4	1E-1E-10E-1E-1E-10E-1E-1E	OZ4
FMS-10Z5	1E-1E-1E-10E-1E-1E-1E-1E	OZ5
FMS-10Z6	1E-1E-1K-1K-1K-1K-10R-1E-1E	OZ6
FMS-10Z7	1E-1E-10E-1E-1E-1E-1E-1E	OZ7
FMS-10Z8	1K-1K-1E-1E-1E-1E-1E-1E-1E	OZ8
FMS-10Z9	1E-1E-1E-1E-10E-1E-1E-10E	OZ9
FMS-10ZA	10-10-10-6-6-6-9	OZA
FMS-10ZB	1-1-1-1-1-1-1-1-1-1-10#	OZB
FMS-10ZC	1-1-1B-1B-1B-1B-1B-1B-1B-1B	OZC
FMS-10ZD	1N-1N-1Y-1Y-1Y-1Y-1Y-1Y-1Y	OZD
FMS-10ZE	10R-10R-10R-1W-1W-1W-1W	OZE
FMS-10ZF	1W-1W-1W-1W-1K-1K-1K-1K-1K	OZF
FMS-10ZG	1-1-1-2K-1K-1K-1K-2K	OZG
FMS-10ZH	10-10-10-10-9-1K	OZH
FMS-10ZI	1-1-1W-1Y-1Y-1Y-1Y-1Y-1Y-1Y	OZI
FMS-10ZJ	1E-1E-1E-1E-1E-1E-1-1-1-1	OZJ
FMS-10ZK	10R-10B-2K-2K-2K	OZK
FMS-10ZL	10B-10-10R-10B-10	OZL
FMS-10ZM	10-10R-10B-10-10R	OZM
FMS-10ZN	10B-10-10R-10B-2	OZN
FMS-10ZO	10R-10R-10R-1G-1G-1G-1G	OZO
FMS-10ZQ	10R-10Y-10B-10-10	OZQ
FMS-10ZR	1B-1B-10R-10Y-10B-10	OZR
FMS-10ZS	1-1Y-1B-1K-10R-10Y-10B	OZS
FMS-10ZT	9-9-9-9-1K-1K-1K-1K-1K-1K	OZT
FMS-10ZU	1-1K-1N-1E-1Y-1W-1W-1-1-1	OZU
FMS-10ZV	2B-1Y-1Y-1Y-1Y-1Y-1Y-1Y	OZV
FMS-10ZW	1Y-1Y-1W-1K-1K-1K-1K-1K-1K	OZW
FMS-10ZX	10-10-1-1-1K-1K-1-1	OZX
FMS-10ZY	1-1W-1-1W-1K-1K-1K-1K-1K-1K	OZY
FMS-10ZZ	1K-1K-1K-1-1-1-1-1K-1K-1K	OZZ

Please refer to the STATES website for more part numbers and up to date information

Color Key: k: Black b: Blue g: Green e: Orange r: Red w: White n: Brown y: Yellow p: Purple

FMS 14 Pole Test Switches

Part Number	Arrangement
FMS14-11A	1-1-1-1-1-1-1-1-1-1-26-26-26
FMS14-11B	10-10-10-10-1B-1B-1B-26-26-26
FMS14-11C	26-26-26-10-10-10-2-16
FMS14-11D	1-1-1K-1K-1K-10-10-10-26-26-26
FMS14-11E	1-1-1-10-10-10-1-1-26-26-26
FMS14-11F	10-10-10-10-1-90Y-26-26-26
FMS14-11G	10-10-10-9-26-26-26-1-1-1-1
FMS14-11H	10-6-6-6-9-10-1-1-1-26-26-26
FMS14-11I	1-1-1-13-13-13-13-26-26-26
FMS14-11J	1K-1K-1K-1K-10-10-10-9-26-26-26
FMS14-11K	1-1G-1-1G-1-1G-1W-1W-1E-1E-26-26-26
FMS14-11M	16-10-10-10-2-26-26-26
FMS14-11P	1K-1K-1K-10-10-10-1K-1K-26-26-26
FMS14-11Q	1K-1K-1K-1K-26-10-10-10-9-26-26
FMS14-11S	1K-1K-1K-1K-26-26-26-11-11-11-9
FMS14-11T	16-10-10-10-26-26-26-2
FMS14-12A	1-1-1-1-1-1-1-1-1-1-1-1-26-26
FMS14-12A1	1K-1K-1K-1K-1K-1K-1K-1K-1K-1K-1K-26-26
FMS14-12AB	1K-1K-1K-1K-1K-1K-1-1-1-1-1-1-26-26
FMS14-12AD	16-1K-26-26-10-10-10-10
FMS14-12AE	10-10-10-1-1-1-1-26-26-1-1-1
FMS14-12AF	#6-6-6-9#-26-#6-6-6-9#-26-#6-6-6-9#
FMS14-12AG	10R-10R-10R-10R-1G-1G-1G-1G-26-26
FMS14-12AH	10-10-10-1K-1K-1K-1K-1K-26-26
FMS14-12AI	6-6-6-9-10-10-1K-1K-1K-26-26
FMS14-12AJ	6-6-6-9-1-1-1-1-1K-1K-1K-26-26
FMS14-12AK	1-1-1-1-1-1-1-10-10-10-26-26
FMS14-12AL	10-10-10-10-10-1-1-26-26
FMS14-12AM	10-10-10-10-1K-1K-1K-1K-26-26
FMS14-12AP	13-13-13-13-9-9-9-9-26-26
FMS14-12AQ	1K-1K-1K-1K-10-10-10-10-26-26
FMS14-12AT	16-10-10-10-24-26-26-1-24
FMS14-12AU	1-1-1-10-10-10-10-1-26-26
FMS14-12AV	26-10-10-10-10-1-1-1-1Y-26
FMS14-12AX	26-1K-1K-1K-1K-1K-1K-10-10-10-26
FMS14-12AY	26-10-10-10-1Y-1Y-1Y-1Y-1Y-26
FMS14-12B	#10-10-10#--26-26-#10-10-10#
FMS14-12BA	1-10-1-10-1-10-1-2B-26-26
FMS14-12BC	16-16-16-16-26-26
FMS14-12BD	10KB-10KB-10KB-26-26-10KB-10KB-10KB
FMS14-12BE	1-1-9-10-10-10-1-10-26-26
FMS14-12BG	1Y-1G-1-1B-1Y-1G-1-1B-1Y-1G-1-1B-26-26
FMS14-12BH	1-1-1-10-10-10-1B-1B-1-26-26
FMS14-12C	1-1-1-1W-26-26-10-10-10-10
FMS14-12D	10-10-10-10-1-1-1K-1K-26-26
FMS14-12E	26-10-10-10-10-1-1-1-1-26
FMS14-12F	10-10-10-10-1B-1B-1B-1B-26-26
FMS14-12G	1B-1B-1B-1B-1B-1B-2B-1B-2B-26-26
FMS14-12H	10-10-10-10-10-10-26-26

FMS 14 Pole Test Switches

Part Number	Arrangement
FMS14-12I	1-1-1-10-1-10-1-10-1-26-26
FMS14-12J	1-1-1-1-10-10-10-1-1-26-26
FMS14-12K	1-10-1-10-1-10-1-1-1-26-26
FMS14-12L	10-10-10-1-1-1-1-26-26-2KW
FMS14-12M	1-10-1-10-1-10-1-10-26-26
FMS14-12N	10-10-10-26-26-10-10-10
FMS14-12P	1-1-1-1-10-10-10-10-26-26
FMS14-12Q	1K-1K-1K-24-10-10-10-26-26
FMS14-12R	1K-1K-1K-1-1-1-1-1-1-1-1K-26-26
FMS14-12S	1B-1B-1B-10-10-10-1B-26-26-1B-1B
FMS14-12T	10-10-10-26-10-10-10-26
FMS14-12U	1K-1K-1K-10-10-10-26-26-1-1
FMS14-12V	1K-1K-1K-1-1-1-1-1-1-1-1-26-26
FMS14-12W	1K-1K-1K-1K-10-10-10-1K-1K-26-26
FMS14-12X	1-1-1-10-10-10-1W-26-26-1-1W
FMS14-12Y	26-10-10-10-10-1K-1K-1K-1K-26
FMS14-12Z	10R-10Y-10B-10-26-26-1-1Y-1B-1K
FMS14-13A	1-1-1-1-1-1-1-1-1-1-1-1-1-26
FMS14-13B	10-9-10-10-10-9-16-26
FMS14-13C	10-10-10-1-1-1-1-1-1-1-26
FMS14-13D	10-10-10-26-1-10-10-10
FMS14-13E	1N-1E-1Y-24-2-26-10-10-10-1B
FMS14-13ER	2-2B-16E-2W-2W-2W-26
FMS14-13F	1G-1-1G-1-1G-1-1-1W-1Y-1Y-26-1-1W
FMS14-14A	1-1-1-1-1-1-1-1-1-1-1-1-1-1
FMS14-14AB	1K-1K-2K-1-1Y-1B-1W-10R-10Y-10B
FMS14-14AC	2K-1-1Y-1B-1W-10R-10Y-10B-10W
FMS14-14AD	1B-1B-1B-1B-1B-1B-10-10-10-10
FMS14-14AE	10-10-10-10-1B-1B-1B-1B-2B
FMS14-14AF	1K-1K-1K-1K-1K-1K-1K-1K-10-10-10
FMS14-14AG	1-1-1-24-1W-1W-1-1G-10-10-10
FMS14-14AH	2K-2K-2K-2K-2K-2K-1-1
FMS14-14AJ	1-1-1-10-10-10-10-1-1-1
FMS14-14AK	1K-1K-1K-1K-1K-1K-1K-10-10-10-9
FMS14-14AL	10E-10E-10E-1B-1B-1B-10E-10E-1B
FMS14-14AM	10E-10E-10E-10E-1B-10E-10E-1B
FMS14-14AN	10-10-10-10-2Y-2-1-1
FMS14-14AP	1K-1K-1-1-1K-1K-1K-10-10-10-9
FMS14-14AQ	1-1-1-1B-1B-1B-10-10-10-10
FMS14-14AR	10-10-10-1K-1K-1K-1K-1-1-1-1
FMS14-14AS	13B-13B-13B-1B-1B-1B-1B-1B-1B-1B
FMS14-14AT	10-10-10-1-1-1-1-1-1-1-1
FMS14-14AU	1-1K-1K-10-10-10-9-10-1K-1K
FMS14-14AV	1-1-1-1-1-9-10-10-10-10
FMS14-14AW	9-10-10-10-9-10-10-10
FMS14-14AX	1Y-1Y-1-1-1-1-10-10-10-10
FMS14-14AY	1-1-1-1-10-10-10-10-10
FMS14-14AZ	1-1-1K-1K-1K-1K-1K-1K-1K-1K-1K-1K

Color Key: k: Black b: Blue g: Green e: Orange r: Red w: White n: Brown y: Yellow p: Purple

FMS Semiflush-Mounted Test Switches

FMS 14 Pole Test Switches

Part Number	Arrangement
FMS14-14A1	1K-1K-1K-1K-1K-1K-1K-1K-1K-1K-1K-1K
FMS14-14B	2-2-2-2-2-2-2
FMS14-14BA	1-10-1-10-1-10-1-10-10
FMS14-14BB	10E-10E-10E-10E-10E-1K-1K-1K-1
FMS14-14BC	10E-10E-10E-10E-10E-10E-1K-1
FMS14-14BD	1Y-1Y-1Y-1Y-1Y-1Y-1Y-1Y-1Y-1Y-1Y-1Y
FMS14-14BE	2K-2K-2K-#1K-1K-1K-1K-#2K-2K
FMS14-14BF	1-1-1-1K-1K-1K-10-10-10-10
FMS14-14BG	10-10-10-10-1B-1B-1B-1B-1B-1B
FMS14-14BH	1K-1K-1K-1K-1-1-1-1-1-1-1-1-1
FMS14-14BI	10-10-10-10-10-10-1B-1B
FMS14-14BJ	1B-1B-10-10-10-10-10-10
FMS14-14BK	10-10-10-10B-1K-1K-1K-1-1-1
FMS14-14BL	1B-1B-1B-1B-1B-1B-1B-1B-1B-1B-1B-1B
FMS14-14BM	1-1-1-1-1-1-1B-1B-1B-1B-1B-1B-1B
FMS14-14BN	1K-1K-1K-1-1-1-1-1-1-1-1-1-1
FMS14-14BO	1K-1K-1K-1K-10-10-10-1K-1K-1K-1K
FMS14-14BP	1K-1K-1K-10-10-10-1K-1-1-1-1
FMS14-14BQ	1B-1B-1B-10-10-10-10-1B-1-1
FMS14-14BR	10-10-10-1K-1K-10-10-10
FMS14-14BS	1-1-1-1-1K-1K-1K-1K-1K-1K-1K-1K-1K
FMS14-14BT	2K-2K-2K-2K-2K-2K-2K
FMS14-14BU	10-10-10-10-1B-1E-1Y-1G-1K-1
FMS14-14BV	10-10-10-9-10-10-10-9
FMS14-14BW	1K-1K-1K-10-10-10-10-1K-1-1
FMS14-14BX	1K-1K-1K-1K-1K-1K-1K-1K-1K-1-1-1-1
FMS14-14BY	1-1-1-1-1-1-1K-1K-1Y-1Y-1Y-1Y-1Y-1Y
FMS14-14BZ	2Y-2Y-2-2-2-2-2BN
FMS14-14C	1-1-1-10-10-10-1-1-1-1-1
FMS14-14CA	1-1-2K-16K-10-10-10-1K
FMS14-14CB	1K-1K-1K-1K-10-10-10-10-10
FMS14-14CC	10R-10R-10R-1B-1B-1B-10R-24-1E-1E
FMS14-14CD	1K-1B-1-1E-10-10B-10R-10E-1K-1K
FMS14-14CE	10-10-10-1K-1K-1K-1K-1K-1K-1K-1K
FMS14-14CF	10-10-10-10-10-10-1K-1K
FMS14-14CG	2Y-2Y-2Y-2Y-2Y-2Y-2Y
FMS14-14CH	10R-10-10B-10R-10-10B-1K-1K
FMS14-14CI	1-1K-1B-1W-10R-10-10B-10W-1K-1K
FMS14-14CJ	1-1-1-10-10-10-1B-1B-1B-1B-1B
FMS14-14CK	10-10-10-10-1K-1K-1K-1K-1K-1K
FMS14-14CL	10-10-10-1-10-10-10-1
FMS14-14CM	1B-1B-1B-1B-10-10-10-10-1-1
FMS14-14CN	1-1-1-1-1E-1E-1Y-1Y-1Y-1Y-1W-1W-1W-1W
FMS14-14CO	1-1-1-1-1-1-1Y-1Y-1Y-1Y-1W-1W-1W-1W
FMS14-14CP	1K-1K-1K-1K-10-10-10-10-1K-1K
FMS14-14CQ	1-1-1-1-1-1-1-1-1K-1K-1K-1K-1K-1K
FMS14-14CR	1-1-1-1-10-10-10-9-1-1-1
FMS14-14CS	10-10-10-1B-1B-1B-1-1-1K-1K-1K
FMS14-14CT	#6-6-6-9#-1-1-1-1-1-1-1-1-1
FMS14-14CU	1-1-1-1-1B-1Y-10-10-10-10
FMS14-14CV	1-10-1-10-1-10-1-1-1-1-1
FMS14-14CW	1-1-1-1-1-1-1-1-1K-2K-1K-1K-1K

FMS 14 Pole Test Switches

Part Number	Arrangement
FMS14-14CX	1-1-1-10-10-10-10-1-1B-1K
FMS14-14CY	6-6-6-9-6-6-6-9-1K-1K-1K-1K-1K
FMS14-14CZ	6-6-6-9-1-1-1-1-1K-1K-1K-1K-1K
FMS14-14D	1K-1K-1K-1K-1K-1K-10-10-10-10
FMS14-14DA	10R-10Y-10B-10-1-1-1-1Y-1B-1K
FMS14-14DB	1-1-1-1-1-1-1K-1K-1K-1K-1K-1K-1K
FMS14-14DC	10-10-10-16-1-1-1-1-1
FMS14-14DD	1-1-1-1-1-1-1-1-1-1-2K-2K
FMS14-14DE	1B-1B-1B-10B-10B-10B-1B-1B-1B-1B
FMS14-14DF	1Y-1Y-1B-1B-1B-1B-1B-1B-1B-1B-1B
FMS14-14DG	1Y-1Y-1B-1B-1B-1B-1B-1B-1B-1B-1W-1W
FMS14-14DH	10-10-10-10-1-1-1-1-1-1K
FMS14-14DI	1-1K-1-1K-1-1K-1-1K-1-1K-1-1K-1-1K
FMS14-14DJ	1K-1K-10-10-10-10-10-10
FMS14-14DK	10-10-10-10-9-9-9-9-9-9
FMS14-14DL	1K-1K-1K-1K-10R-10R-10R-1B-1B-1E-1E
FMS14-14DM	9-9-9-9-9-9-9-9-9-9-9-9
FMS14-14DN	1B-1B-1B-1B-1Y-1Y-10-10-10-10
FMS14-14DO	1-1-1-24-1Y-1Y-10-10-10-10
FMS14-14DP	1B-1B-1B-1B-1Y-1Y-1-1-1-1-1-1-1
FMS14-14DQ	1-1-1B-1B-1B-1B-10-10-10-10
FMS14-14DS	6-6-6-9-1K-1K-1K-1K-1-1-1-1-1-1
FMS14-14DT	6-6-6-9-6-6-6-9-10-1-1-1-1
FMS14-14DU	1-1-1B-1B-1W-1W-1-1-1B-1B-1W-1W-1-1
FMS14-14DV	1-1K-1-1K-1-1K-10E-10Y-10W-10B
FMS14-14DW	1-1-10Y-10W-10B-10Y-10W-10B
FMS14-14DX	2Y-2Y-2-2-2-2-2
FMS14-14DY	10-10-10-10-10-1-1-1-1
FMS14-14DZ	1-1-1-1-10-10-10-10-1B-1B
FMS14-14E	10-10-10-10-10-10-1-1
FMS14-14EA	1-1K-1-1K-1-1K-10RK-10RK-10RK-1K-1K
FMS14-14EB	1-10-10-10-10-1-1K-1K-1-1
FMS14-14EC	10-10-10-1K-1K-1K-1K-1K-1K-1K-1
FMS14-14ED	1-1-10-1-1-10-1-1-10-10
FMS14-14EF	1-1-1-1-1-1-10-10-10-1K-1K
FMS14-14EG	10-10-10-1-1-1-1-1-1-24-24
FMS14-14EH	1K-1K-1K-1K-1K-1K-10-10-10-1K-1K
FMS14-14EI	1K-1K-1K-1K-1K-1K-1K-1-1-10-10
FMS14-14EJ	1K-1K-1K-1K-1K-1K-1K-1K-1K-1K-1K-1E
FMS14-14EK	1K-1K-1K-1K-1K-1K-1K-1K-1K-1K-1K-1-1
FMS14-14EL	6-24/6-24/6-24/10-10-10-1K-1K
FMS14-14EM	1K-1K-1K-1K-1K-1K-1K-1K-1K-1K-1K-10
FMS14-14EN	1K-1K-1K-1K-1K-1K-1-1-1-1-1-1-1
FMS14-14EO	1K-1K-1K-10-10-10-1K-1-1-1-1
FMS14-14EP	1K-1K-1K-1-1-1-1-1-1-1-1-1-1K
FMS14-14EQ	1K-1K-1K-1K-1K-1K-1K-1-1-1-1-1-1
FMS14-14ER	2-2B-2W-2W-2W-2W-2W
FMS14-14ES	2W-2W-2W-2W-2W-2W-2W
FMS14-14ET	#6-6-6#-9-#6-6-6#-9-#6-6-6#-9-1-1
FMS14-14EU	10B-10W-10R-10K-1B-1W-1-24-1W-24
FMS14-14EV	1-1-1-10-10-10-10-10-10
FMS14-14EW	1K-1K-1K-1K-1K-1K-10-1K-1K-1K-1K-1K

Color Key: k: Black b: Blue g: Green e: Orange r: Red w: White n: Brown y: Yellow p: Purple

FMS 14 Pole Test Switches

Part Number	Arrangement
FMS14-14EX	1Y-1Y-1Y-1Y-1Y-1Y-1Y-1Y-1-1-1-1-1
FMS14-14EY	10EK-10EK-10EK-10EK-10EK-10EK-10EK-10EK
FMS14-14F	10-10-10-10-1-1-1-1-1-1
FMS14-14FA	10R-10R-10R-10R-1K-1K-1K-1K-1E-1E
FMS14-14FB	1K-1-1-1K-1K-1K-10-10-10-10
FMS14-14FC	1K-1K-1-1-1-1-1-1-1-1-1-1-1
FMS14-14FD	1K-1K-1K-10-10-10-10-1-1-1
FMS14-14FE	1-1-1K-1K-10-10-10-10-1K-1K
FMS14-14FF	1K-1K-1K-10-10-10-10W-1-1-1
FMS14-14FG	10-10-10-1Y-1Y-1Y-1Y-1Y-1Y-1Y-1Y
FMS14-14FH	9-1-1Y-1B-1G-10-10-10-1E-1E-9W
FMS14-14FI	9-10-10-10-1N-1N-1N-1E-1E-1E-9W
FMS14-14FK	9-10-10-10-10-10-10-9W
FMS14-14FM	20-9-1K-1K-1K-1K-1K-1K-1K-1K-1K-1K
FMS14-14FN	10-10-10-1-1-1-1-1B-1B-1B-1W
FMS14-14FO	10-10-10-1B-1B-10-10-10
FMS14-14FP	10-10-10-10-1-1-10-10
FMS14-14FQ	10-1-1-1-1-1-1B-1B-1B-1B-1B-1B-1B
FMS14-14FR	1N-1B-1B-1B-1B-1B-1B-1B-1Y-1W-1W-1W-1W-1W
FMS14-14FS	1-1-1-1-10-10-10-2-2
FMS14-14FT	10-10-10-1B-1B-1B-1B-1-1-1-1
FMS14-14FU	1K-1K-1K-24-10-10-10-10-1K-1K
FMS14-14FV	10R-10R-10R-10R-1G-1G-1G-1G-1G-1G
FMS14-14FW	10Y-10Y-10Y-1K-1K-1K-1K-1K-1-1-1
FMS14-14FX	16-1B-2RK-10-10-10-10
FMS14-14FY	1-1-1-1-1-1-1-1-1-1-1B-1B-1B-1B
FMS14-14G	10-10-10-10-10-10-10
FMS14-14GA	10Y-10Y-10Y-10Y-10Y-10Y-10Y
FMS14-14GB	1W-1W-1W-1W-1-1-10Y-10Y-10Y-10Y
FMS14-14GH	1K-1K-1K-1K-10-10-10-10-1-1
FMS14-14GI	10-10-10-10-1K-1K-1K-1K-1-1
FMS14-14GJ	1-10-10-10-10-10-10-1
FMS14-14GK	1-#10#-#10#-#10#-#10#-#10#-#10#-1
FMS14-14GL	10-10-10-10-1-1-1K-1K-1K-1K
FMS14-14GM	10-10-10-10-1B-1B-1B-1B-2
FMS14-14GN	1-1K-1K-1K-1K-10-10-10-10-9
FMS14-14GO	2K-1E-1E-1E-1E-10R-10Y-10B-10W
FMS14-14GP	1-1-10-10-10-10-10-10
FMS14-14GQ	1-1-1-1-10-10-10-1-1-1-1
FMS14-14GR	10-10-10-1B-1B-1B-1B-1-1-1Y-1Y
FMS14-14GS	10-10-10-1-1-1Y-1Y-1Y-1Y-1Y-1Y
FMS14-14GT	10-10-10-10-1-1Y-1Y-1Y-1Y-1Y
FMS14-14GU	10-10-10-10-1B-1B-1B-1Y-1Y-1Y
FMS14-14GV	10-10-10-1B-1B-1B-1Y-1Y-1Y-1Y-1Y
FMS14-14GW	10-10-10-1-1-1-1-1K-1K-1K-1K
FMS14-14GX	10-10-10-1-1-1-1-1Y-1Y-1Y-1Y
FMS14-14GY	1K-1K-1K-10-10-10-1W-1K-1K-1B-1E
FMS14-14H	1K-1K-10-10-10-10-10-1K-1K
FMS14-14HA	1K-10-10-10-10-10-10-1K
FMS14-14HB	1E-1E-1E-1E-1E-1E-1E-1E-1W-1W-1W-1E-1E
FMS14-14HC	1W-1B-1B-1B-1B-1B-1B-1B-1B-1B-1W-1W
FMS14-14HD	1W-1W-1W-1W-1W-1W-1W-1W-1W-1W-1W-1W

FMS 14 Pole Test Switches

Part Number	Arrangement
FMS14-14HE	1-1-1-1-1-1-1-1-10-10-10
FMS14-14HF	1B-1B-1B-1B-1B-1Y-1Y-1-10-10-10
FMS14-14HG	10-10-10-10-1Y-1Y-1B-1B-1B-1B
FMS14-14HI	1B-1B-1B-1B-1Y-1Y-1-1-10-10-10
FMS14-14HJ	10R-10R-10R-1K-1K-10Y-10Y-10Y
FMS14-14HK	10-10-10-1B-1B-1B-1B-1B-1B-1Y-1Y
FMS14-14HL	10R-10R-10R-10R-10R-10R-10R
FMS14-14HM	1B-1B-1B-10-10-10-1B-1K-1K-1K-1K
FMS14-14HN	1K-10-10-10-1K-1K-1K-1K-1K-1K-1K
FMS14-14HO	1K-1K-1K-1K-1-1-1-1-1K-1K-1K-1K-1K-1K
FMS14-14HP	1B-1B-1K-1K-1K-1K-1K-1K-1K-1K-1K-1K-1K
FMS14-14HQ	1K-1K-1-1-1K-1K-1K-1K-1K-1K-1K-1K-1K
FMS14-14HR	1-1-1-1-1K-1K-1K-1K-1K-1K-1K-1K-1K-1K
FMS14-14HS	1-1-1-1-10-10-10-1W-1W-1W-1W
FMS14-14HT	1K-10-10-10-10-1K-1K-1K-1K-1K
FMS14-14HU	1K-1K-1K-1K-1K-1-1-1-10-10-10
FMS14-14HV	10-10-10-1K-10-10-10-1K
FMS14-14HW	2Y-2Y-2K-2-2-2-2
FMS14-14HX	1-10-10-10-1-1-1-1B-1B-1B-1B
FMS14-14HY	1E-1B-1G-24-10KW-10YW-10RW-#1-1K-1Y-1Y#
FMS14-14HZ	1-10-1-10-1-10-1G-1G-1G-1G-1G
FMS14-14I	10-10-10-10-10-2-2
FMS14-14IA	10W-10W-10W-10W-1-1-1-1-1-1
FMS14-14IB	10W-10W-10W-10W-10W-10W-1-1
FMS14-14IC	10-10-10-6-6-6-9-10-1K-1K
FMS14-14ID	6-6-6-9-6-6-6-9-10-10-1K-1K
FMS14-14IE	1K-1K-1K-1K-10-10-10-1-1-1-1
FMS14-14IF	1-1-1B-1B-1B-1B-1B-1B-1B-1B-1B-1B
FMS14-14IG	1-1W-1G-1Y-1B-1E-1N-1K-1K-1K-1K-1K-1K
FMS14-14IH	10-10-10-9-9-10-10-10 (#9 without blade)
FMS14-14IJ	10-10-10-10-1-1-1-1W-1Y-1Y
FMS14-14IK	1-10-10-10-10-1-1-1-1-1
FMS14-14IL	1-1Y-1B-1K-1K-1K-10R-10Y-10B-10
FMS14-14IM	10R-10Y-10B-10-10R-10Y-10B
FMS14-14IN	10-10-10-10-10W-10W-10W
FMS14-14IO	1E-1E-1E-10-10-10-1E-10-1-1G
FMS14-14IP	6-6-6-9-6-6-6-9-10-1K-1K-1K-1K
FMS14-14IQ	16-#6-6-6-5#-1B-1B-1B-1B-1B-1B-1B
FMS14-14IR	10R-10Y-10B-1-1Y-1B-1K-1K-1K-1K-1K
FMS14-14IS	10B-10B-10B-10B-1-1-1-1-1-1
FMS14-14IT	10-10-10-10-2K-16K-24
FMS14-14IU	1K-1K-1K-10-10-10-24-1K-1K-1K-24
FMS14-14IV	10-1K-10-1K-10-1K-10-1K-1K-1K
FMS14-14IW	10-10-10-10-2-2-2
FMS14-14IX	10-10-10-2-2-2-2
FMS14-14IY	1-1-1-1-10-10-10-10-2
FMS14-14IZ	10-10-10-10-1K-1K-1K-2-1K
FMS14-14J	1K-1K-1G-1Y-1B-1B-1-1-1-1-1-1-1
FMS14-14JA	1K-1K-1K-10-10-10-10-1K-1-1K
FMS14-14JB	16-1-1K-1K-10-10-10-10
FMS14-14JC	1K-1K-1-1-1-1B-1B-1B-1Y-1Y-1Y-1Y-1Y
FMS14-14JD	1Y-1Y-1Y-1Y-1B-1B-1B-1B-1B-1B-1B-1B

Color Key: k: Black b: Blue g: Green e: Orange r: Red w: White n: Brown y: Yellow p: Purple

FMS Semiflush-Mounted Test Switches

FMS 14 Pole Test Switches

Part Number	Arrangement
FMS14-14JE	1B-1B-1-1-1-1-1-1-1-1-1-1-1-1-1-1
FMS14-14JF	10-10-10-10-1K-1K-1K-1-1-1
FMS14-14JG	10-10-10-1E-1E-1E-1E-1E-1B-1B-1B
FMS14-14JH	10-1B-1B-1B-1B-1B-1B-1B-1B-1E-1E-1E-1E
FMS14-14JI	1-1-1-10-10-10-10-1-1-1-1B-1B
FMS14-14JJ	1-1-1-10-10-10-10-10-1B-1B-1B
FMS14-14JK	2-10-10-10-10-10-10
FMS14-14JL	1-1K-1K-1K-1K-10-1K-1K-1-1-1-1-1
FMS14-14JM	16-#6-6-6-6-5#-1B-1B-1B-1B-1B-1B
FMS14-14JN	1-1-1-1-#6-6-6-6-5#-1B-1B-1B-1B-1B
FMS14-14JO	10-10-10-10-1-1-1-1-1Y-1Y
FMS14-14JP	10-10-10-24-1-1-1-1-1-1-1
FMS14-14JQ	1K-1K-1K-1K-1K-1K-1W-1W-1W-1W-1W-1W-1W-1W
FMS14-14JR	1-1-1K-1K-1K-9-10-10-10-10
FMS14-14JT	1Y-1E-1E-1-1-1-10-10-10-10
FMS14-14JU	10-10-10-10-16-24-2
FMS14-14JV	1-1-1-1-1K-1K-1K-1K-10-10-10
FMS14-14JW	10B-10B-10B-10B-2K-16K-1K
FMS14-14JX	1-1-1-10-10-10-10-1K-1K-1K
FMS14-14JY	10-10-10-1-1-1K-1K-1K-1K-1K-1K
FMS14-14JZ	#6-6-6-9#-#6-6-6-9#-#6-6-6-9#-10
FMS14-14K	1K-1K-1K-10-10-10-1K-1-1K-1K-1K
FMS14-14KB	1Y-1-1-1-10-10-10-10-10
FMS14-14KC	#6-6-6-9#-10-10-1-1-1-1-1-1
FMS14-14KF	#6-6-6-9#-#6-6-6-9#-1-1-1-1-1-1
FMS14-14KG	1-1-1-1-2-10-10-10-10
FMS14-14KH	1-1-1-1-2RK-10-10-10-10
FMS14-14KI	10-1Y-1Y-1Y-1Y-1Y-1Y-1Y-1Y-1Y-1Y-1Y
FMS14-14KJ	1-1-9-10-10-10-1-10-10
FMS14-14KL	#6-6-6-9#-#6-6-6-9#-10-1-1-1-1-1
FMS14-14KM	1K-1K-1K-24-10-10-10-10-1-1
FMS14-14KN	1K-1K-1K-1E-1E-1E-6W-6W-6W-1W-2-2
FMS14-14KP	1-1K-1K-1K-1K-1K-1K-10-10-10-9
FMS14-14KQ	16-2-#6-6-6-6-5#-1B-1B-1B-1B
FMS14-14KR	#6-6-6-5#-#6-6-6-5#-#6-6-6-5#-1K-1K
FMS14-14KS	#1-1-1-1#-1B-1B-1B-1B-1B-1B-1B-1B-1B
FMS14-14KT	2K-2K-2K-2K-2K-2K-2
FMS14-14KU	2K-2K-2K-2-2-2-2
FMS14-14KV	1E-1E-1E-1E-10-10-10-10-1G-1
FMS14-14KW	1-1-10-10-10-10-1-1-1-1
FMS14-14KZ	1-1-1-1-1-1-1-1-1-1-1-1-1-1-10
FMS14-14L	1-1-1-1-1B-1B-10-10-10-10

FMS 14 Pole Test Switches

Part Number	Arrangement
FMS14-14LA	10-10-10-10-1-1-1-1B-1B-1B
FMS14-14LB	10-10-10-9-10Y-10Y-10Y-9Y
FMS14-14LC	1-1-1-24-10-10-10-1B-1B-1B-1B
FMS14-14LD	#10-10#-#10B-10B#-#10G#-#10W#1Y-1
FMS14-14LE	1-10-1-10-1-10-1-1-1-1B-1B
FMS14-14LF	1-1-1-1-1-1-1-1-1-1-#6-6-6-9#
FMS14-14LG	#6-6-6-9#-1-1-1-1-1-1-1-#6-6-6-9#
FMS14-14LH	2-2-1-1-1-1-1-1-1-1-1-1
FMS14-14LI	2K-16-10-10-10-10-1W
FMS14-14LJ	2-2-2-2-2-2-1-1
FMS14-14LK	1-1-1-1-1-1-1-1-1-1K-1K-1K-1K-1K
FMS14-14LM	10-10-10-1K-1K-1K-1-1-1-1-1
FMS14-14LN	10-10-10-10-10-10-2K
FMS14-14LO	10-10-10-1K-1K-1K-1-1-1-2
FMS14-14LP	1-1G-1-1G-1-1G-1-1W-1Y-1Y-1Y-1N-1-1W
FMS14-14LQ	10-10R-10B-10-10R-10B-10W
FMS14-14LR	1E-1E-1E-10-10R-10B-10W-1K-1-1B
FMS14-14LS	1E-1E-1E-1E-1E-1E-1E-1K-1-1B-10-10R
FMS14-14LT	10B-10-10R-10B-10-10R-10B
FMS14-14LU	1E-1E-1E-1E-1E-1E-1E-1E-1E-1E-1E-1E
FMS14-14LV	10-10-10-10-1K-1K-1K-1K-1K-1
FMS14-14LW	10-10-10-10B-10B-10B-10W
FMS14-14LX	11-11-11-9-11-11-11-9
FMS14-14LY	1Y-1E-10-10-10-10-10-10
FMS14-14M	1-1-1-10-10-10-1W-1G-1E-1Y-1B
FMS14-14MA	10R-10R-10R-10R-1K-1K-1K-1K-1K-1K
FMS14-14MB	10Y-10Y-10Y-1K-1K-1K-1K-1-1-1-1
FMS14-14MC	1W-1W-1W-1W-1W-1W-1W-1W-1B-1B-1B-1B-1B
FMS14-14N	16-1-2-10-10-10-10
FMS14-14P	16-1-10-10-10-10-1B-1B
FMS14-14Q	1-1-1-10-10-10-1-10-1-1
FMS14-14R	10-10-10-10-10-10-2
FMS14-14S	#10#-#10#-#10#-1-#10#-#10#-#10#-1
FMS14-14T	1-10-1-10-1-10-1-10-1-1
FMS14-14U	1K-1K-1K-10-10-10-1K-1K-1K-1K-1K
FMS14-14V	1-1-1-10-10-10-10W-1W-1K-1K
FMS14-14W	1-1-1-1-10-10-10-10-1-1
FMS14-14X	1K-1K-2B-1-1Y-1B-1W-10R-10Y-10B
FMS14-14Y	1K-1K-1K-10-10-10-10-1K-1K-1K
FMS14-14Z	1-1-1-1-1-1-10-10-10-10

Please refer to the STATES website for more part numbers and up to date information.

FMS ACCESSORIES

PART No.	DESCRIPTION
680001	White Marker Handle Tags
50548-xx	Handle Ganging Kit - Replace the "xx" with the required number of adjacent poles to be ganged together (example: 50548-2 - 2 Pole Kit)
50898	10 Pole Hardware Kit (for Screw Terminals)
801034	14 Pole Hardware Kit (for Screw Terminals)
PR1404-100	Hex Nut 10-32 x 5/16 W x 14/64 Thick, Brass Nickel Plate (100pcs per bag)
XNT126-100	Hex Nut 10-32 x 5/16 W x 7/64 Thick, Brass Nickel Plate (100pcs per bag)
FMSLOCK-1	Cover Lock-out Kit for 10, 14, or 30 Pole Clear Wide Cover (includes lock-out bracket and mounting screws)
2003-016	10 Pole Black BACK Cover (for bases that include insert on back of switch base - see picture for example)
2003-017	14 Pole Black BACK Cover (for bases that include insert on back of switch base - see picture for example)
FMSKIT-10N	10 Pole Clear Narrow Cover Kit - includes cover, cover knobs and cover stud hardware
FMSKIT-14N	14 Pole Clear Narrow Cover Kit - includes cover, cover knobs and cover stud hardware
FMSKIT-30N	30 Pole Clear Narrow Cover Kit - includes cover, cover knobs and cover stud hardware
FMSKIT-10	10 Pole Clear Wide Cover Kit - includes cover, cover knobs and cover stud hardware
FMSKIT-14	14 Pole Clear Wide Cover Kit - includes cover, cover knobs and cover stud hardware
FMSKIT-30	30 Pole Clear Wide Cover Kit - includes cover, cover knobs and cover stud hardware
FMSKIT-10B	10 Pole Black Narrow Cover Kit - includes cover, cover knobs and cover stud hardware
FMSKIT-14B	14 Pole Black Narrow Cover Kit - includes cover, cover knobs and cover stud hardware
FMSKIT-30B	30 Pole Black Narrow Cover Kit - includes cover, cover knobs and cover stud hardware

Please refer to our website for accessory pictures.